

Date: 11-21-23

Re: Addendum No. 1 to the Bidding Documents for Security and Access Control Upgrades at The Riverview Psychiatric Center

This ADDENDUM is issued to modify, explain or correct the Drawings and Specifications, and is hereby made a part of the Contract Documents.

NOTICE TO ALL BIDDERS: Please read the entire ADDENDUM for references to all aspects of the Work. This ADDENDUM shall be binding upon the Contractor and he shall furnish and install labor and materials indicated to be furnished and installed by him herein even though such Work is not graphically mentioned in the Drawings and Specifications.

Bidder shall acknowledge receipt of the ADDENDUM on the Bid Form by writing the addendum number for each addendum in the space provided.

GENERAL

- A. Refer to the Attendance list, attached, for a list of contractors in attendance at the mandatory pre-bid walk through conducted on Thursday, November 16, 2023.

- B. Items discussed at the pre-bid meeting:
 1. Project summary: The project scope will replace, in their entirety the existing antiquated video surveillance, Access Control, and Duress systems throughout all areas of the facility.
 2. The project will require 100% Performance and Payment Bonds.
 3. Davis Bacon wage rates apply to the project.
 4. The work shall be completed in a manner which maintains the existing systems operational until such time as the new systems are fully commissioned and operational so that, at no time, with the exception of strictly scheduled shutdowns, are the systems ever off line. A list of areas that are required to have cameras active at all times will be provided in Addenda 2.
 5. Specific phasing and work practice/execution requirements are outlined in Section 011000-Summary of Work. Although our intent is that the means and methods of execution be the contractor's responsibility, there are specific site requirements outlined therein that must be adhered to.
 6. Quiet time shall be maintained in the facility from 7:00 PM to 7:00 AM.
 7. Although there are less employees in the building on weekends, resident population is the same all days. It is anticipated that most work may occur during normal business hours.
 8. The work shall be completed under a lump sum contract, the successful contractor will be responsible for all work incidental to the contract requirements such as ceiling removal/replacement, line voltage circuiting, firestopping, and cutting/patching.
 9. Contractors working in the building will be required to be escorted by representatives of Riverview Psychiatric Center (RPC) at all times. Additionally, contractors will be required to attend training sessions relative to facility HIPPA requirements. **Background checks may be required for personnel working in the building.**
 10. Contractors will be required to fill out a safety form prior to working in the facility.

11. Work practices within the facility may be impacted by such factors as COVID outbreak, under which conditions contractors may have limited access to certain spaces and be required to don personal protective gear as stipulated by RPC.
12. As noted in the project specifications, single vendor/manufacturer has been chosen on which to base the design. This basis of design contractor/vendor was chosen based upon several presentations to the RPC representatives. With that said, however, it is not the intent to be proprietary in the selection of authorized manufacturers and installers. Alternate manufacturers and vendors will be considered as outlined in Article 17 of the Standard General Conditions. To that end, and also as required in the contract documents, companies seeking to provide a bid for the project shall be required to submit a qualification package for our consideration in demonstrating their ability to comply with and meet the requirements outlined in the Technical Specifications for each system. Included herein is a revised schedule for bidding which includes a deadline for submission of such qualifications packages for our consideration.
13. It will be very important that the successful contractor provide prompt response time for facility calls both during and after construction and installation of the systems.
14. Project is scheduled for completion in approximately six months.
15. RPC currently occupies a remote facility at 5 Cauldwell Street in Augusta, Maine. The extent to which that facility's access control and surveillance system are required to integrate with the new system is not yet know. This will be addressed in Addendum #2.

ITEMS ASKED/DISCUSSED AT THE PRE-BID WALKTHROUGH:

- A. Are the existing system analog or digital?
Response: There is a mix of both.
- B. Who manufactures the existing systems?
Response: The existing video surveillance system is by Geovision. One of the largest downfalls to this system is its inability to integrate with other systems. That is a desired/required feature for the new system. The existing access control is Win Pak. The existing duress system is Status Solutions.
- C. Will wiring need to be run in conduit?
Response: Yes, as specified in Specification 261000
- D. Can existing cabling be re-used?
Response: Yes, if it meets current code, spec requirements, is concealed, and in good condition with no defects.
- E. Are their any special cabling requirements given the secure nature of the facility?
Response: Refer to specification 261000. All wiring and cabling shall be in conduit and concealed.

QUESTIONS RECEIVED OF CONTRACTORS VIA EMAIL:

- A. We noticed reference to an electronic fence and intrusion system. Could you please provide us with specifications on these 2 systems that require integration to the ISMS/AMTs?

Response: The electronic fence is to be deleted. Refer to "Changes to the Drawings" and "Changes to the Specifications" herein.

GENERAL:

- A. Contractors seeking to be considered for approval and who were in attendance at the mandatory pre-bid meeting shall submit their qualification packages as outlined in Article

17 of the Standard General Conditions by **2:00 PM on November 30, 2023**. We will issue a notice of acceptance or rejection by December 07, 2023. RPC may request a formal presentation from each contractor prior to making a formal decision. Additional time for bidding will be considered at that time.

CHANGES TO THE SPECIFICATIONS:

- A. Section 001113-Notice to Contractors: **Change** the Bid Date in Paragraph 1. **From** 2:00 PM on November 28, 2023 **To** 2:00 PM on December 19, 2023.

- B. Section 28 10 00 – Access Control:
DELETE Paragraph 2.1 B. in its entirety. **ADD** in its place the following:

“ A. Alternate manufacturers and installers will be considered for approval provided minimum requirements for performance, service, and integration as specified herein are met. Contractors seeking approval shall submit qualifications as outlined in Article 17 of the Standard General Conditions prior to submitting a bid. Additionally, alternate manufacturers may be required to assemble a presentation for the Owner which includes qualifications, capabilities, features, and demonstration for all aspects of their proposed access control system.”

DELETE Paragraph 2.57, 2.58, and 2.61 each in their entirety.

ADD Paragraph 2.60, L:

L: Disturbance sensors shall be Gallagher Z20. Secure sensors to existing fencing using tamperproof clamps and screws. Provide as shown on drawings maximum 20’ apart and provide 10% spare sensors.

Cabling shall be Gallagher Extend HBUS outdoor C303901 twisted pair/power cable. Secure cabling to fence with tamperproof zip ties. Route cabling around gates in ¾” PVC conduit underground .

Provide controllers as required.

- C. Section 28 20 00 – Video Surveillance: **DELETE** Paragraph 2 in Part 2 in its entirety. **ADD** in its place the following:

“ A. Alternate manufacturers and installers will be considered for approval provided minimum requirements for performance, service, and integration as specified herein are met. Contractors seeking approval shall submit qualifications as outlined in Article 17 of the Standard General Conditions prior to submitting a bid. Additionally, alternate manufacturers may be required to assemble a presentation for the Owner which includes qualifications, capabilities, features, and demonstration for all aspects of their proposed video surveillance system.”

- D. Section 28 30 00 – Duress Alarm System: **DELETE** Paragraph 2.1 B. in its entirety. **ADD** in its place the following:

“ A. Alternate manufacturers and installers will be considered for approval provided minimum requirements for performance, service, and integration as specified herein are met. Contractors seeking approval shall submit qualifications as outlined in Article 17 of the Standard General Conditions prior to submitting a bid. Additionally, alternate manufacturers may be required to assemble a presentation for the Owner which includes qualifications, capabilities, features, and demonstration for all aspects of their proposed duress alarm system.”

CHANGES TO THE DRAWINGS:

- A. Sheet E-000 – Abbreviations and Notes: **DELETE** the sheet in its entirety. **ADD** in its place Sheet E-000 – Abbreviations and Notes, attached with revisions.
- B. Sheet E-101 – First Floor Seg. A-Security Plans: **DELETE** the sheet in its entirety. **ADD** in its place Sheet E-101 – First Floor Seg. A-Security Plans, attached with revisions.
- C. Sheet E-102 – First Floor Seg. B-Security Plans: **DELETE** the sheet in its entirety. **ADD** in its place Sheet E-102 – First Floor Seg. B-Security Plans, attached with revisions.
- D. Sheet E-103 – First Floor Seg. C-Security Plans: **DELETE** the sheet in its entirety. **ADD** in its place Sheet E-103 – First Floor Seg. C-Security Plans, attached with revisions.

Attachments: Pre-bid Attendance Sheet; Sheets E-000, E-101, E-102, and E-103

END OF ADDENDUM #1



PRE-BID MEETING SIGN IN SHEET

Date: November 16, 2023

Project: Security and Access Control Upgrades at Riverview Psychiatric Center

Name	Representing	Phone	E-mail
Tony Davis	Allied Engineering	(207) 838-8396	anthony.davis@salasobrien.com
Patrick Cotter	Allied Eng.	774-994-0734	PATRICK.COTTER@SALASOBIEN.COM
Roscoe Grant	Johnson Controls	207-766-8289	roscoe.grant@jei.com
Kathryn Lomax	IPC	207-624-4675	Kathryn.Lomax@maine.gov
Deb Proctor	RPC	207-624-4647	deborah.proctor@maine.gov
Eva Schaible	Phelan Construction	978-219-2742	eschaible@phelanconstruction.com
Snyder Gagnon	M. Nutman Security	207-934-9175	sgagnon@m.nutmanst.com
Ryan Hagerman	Unlimited Tech	585-469-0490	rhagerman@UTIGlobal.com
Paul Desjardis	UTI	484-447-2886	Paul.Desjardis@UTIGlobal.com
Joseph Silva	Riverview	207-624-4646	Joseph.Silva@Maine.gov

Please return this sheet to Allied engineering, Inc.

A	AMPERE	MLO	MAIN LUG ONLY
AC	ALTERNATING CURRENT	MT	MOUNT
AFF	ABOVE FINISHED FLOOR	MTS	MANUAL TRANSFER SWITCH
AFG	ABOVE FINISHED GRADE	MCP	MOTOR CONTROL PANEL
AHU	AIR HANDLING UNIT	MH	METAL HALIDE
AIC	AMPERES INTERRUPTING CAPACITY	MDP	MAIN DISTRIBUTION PANEL
ATS	AUTOMATIC TRANSFER SWITCH	MIN	MINIMUM
AWG	AMERICAN WIRE GAUGE	N	NEUTRAL
BAS	BUILDING AUTOMATION SYSTEM	NC	NORMALLY CLOSED
BKBD	BACKBOARD	NEC	NATIONAL ELECTRICAL CODE
C	CONDUIT	NEMA	NATIONAL ELECTRICAL MANUFACTURERS ASSOCIATION
CAT	CATALOG, CATEGORY	NFPA	NATIONAL FIRE PROTECTION ASSOCIATION
CATV	CABLE TV		
CB	CIRCUIT BREAKER	NIC	NOT IN CONTRACT
CCTV	CLOSED CIRCUIT TELEVISION	NF	NON-FUSED
CM	CIRCULAR MILS	NO	NORMALLY OPEN
COMM	COMMUNICATIONS	NO., #	NUMBER
CU	MECH CONDENSING UNIT	NTS	NOT TO SCALE
CU	COPPER	OC	ON CENTER
CUH	CABINET UNIT HEATER	OCC	OCCUPANCY
DC	DIRECT CURRENT	OH	OVERHEAD
DDC	DIGITAL DIRECT CONTROL	P	POLE
DN	DOWN	PA	PUBLIC ADDRESS
DW	DISHWASHER	PB	PULLBOX
DWG	DRAWING	PH	PHASE
EF	EXHAUST FAN	PIR	PASSIVE INFRARED
ELEV	ELEVATOR	PNL	PANELBOARD
EMT	ELECTRICAL METALLIC TUBING	P/O	PART OF
EP	EXPLOSION PROOF	PV	PHOTOVOLTAIC
ERU	ENERGY RECOVERY UNIT	PVC	POLY-VINYL CHLORIDE
EWC	ELECTRIC WATER COOLER	REC	RECEPTACLE RECEIPT
FACP	FIRE ALARM CONTROL PANEL	REF	REFRIGERATOR
FB	FLOOR BOX	RF	RETURN FAN
FLA	FULL LOAD AMPS	RGS	RIGID GALVANIZED STEEL
FWE	FURNISHED WITH EQUIPMENT	RM	ROOM
G, GND	GROUND	RM	ROOM
GFCI	GROUND FAULT CIRCUIT INTERRUPTER	RMC	RIGID METAL CONDUIT
		RTU	ROOFTOP UNIT
GFP	GROUND FAULT PROTECTION	REF	REFRIGERATOR
HID	HIGH INTENSITY DISCHARGE	SF	SUPPLY FAN
HOA	HAND-OFF-AUTO SELECTOR SWITCH	ST	SHUNT TRIP
HP	HORSEPOWER	SPDT	SINGLE POLE, DOUBLE THROW
HVAC	HEATING, VENTILATION AND COOLING UNIT	SQ	SQUARE
IDS	INTRUSION DETECTION SYSTEM	TEL	TELEPHONE
IG	ISOLATED GROUND	TVSS	TRANSIENT VOLTAGE SURGE SUPPRESSOR
IMC	INTERMEDIATE METAL CONDUIT	TYP	TYPICAL
IR	INFRARED	UF	UNDER FLOOR
K	KILO	UG	UNDERGROUND
KCMIL	KILO CIRCULAR MILS	UH	UNIT HEATER
KW	KILOWATT	UL	UNDERWRITER'S LABORATORY
KVA	KILO VOLT-AMPS	UNO	UNLESS NOTED OTHERWISE
LAN	LOCAL AREA NETWORK	UPS	UNINTERRUPTIBLE POWER SUPPLY
LC	LIGHTING CONTACTOR		
LF	LINEAR FEET	V	VOLTS
LC	LOADCENTER	VFD	VARIABLE FREQUENCY DRIVE
LCP	LIGHTING CONTROL PANEL	W	WATT
LED	LIGHT EMITTING DIODE	WP	WEATHERPROOF
LTG	LIGHTING	WG	WIREGUARD
LTS	LIGHTS	XFMR	TRANSFORMER
MAX	MAXIMUM		
MCB	MAIN CIRCUIT BREAKER	(E)	EXISTING ITEM TO REMAIN
MECH	MECHANICAL	(R)	REMOVE ITEM AND DISPOSE OF PROPERLY
MH	MOUNTING HEIGHT	(ER)	RELOCATED ITEM AT NEW LOCATION
MC	MICROPHONE	(RL)	REMOVE AND RELOCATE
MW	MICROWAVE		

PROJECT NOTES

- THE SCOPE OF WORK SHALL INCLUDE PROVIDING ALL WORK INDICATED UNLESS OTHERWISE SPECIFICALLY INDICATED AS EXISTING OR WORK BY OTHERS, AND COORDINATION WITH ALL TRADES SCOPE OF WORK AS INDICATED ON THE CONTRACT DOCUMENTS INCLUDING BOTH THE DRAWINGS AND THE SPECIFICATIONS, WHICH ARE COMPLEMENTARY. WORK REQUIREMENTS INDICATED IN ANY CONTRACT DOCUMENT SHALL BE CONSIDERED PART OF THE SCOPE OF WORK, UNLESS SPECIFICALLY INDICATED AS EXISTING OR WORK BY OTHERS.
- IN GENERAL, WORK REQUIREMENTS ARE NOT INDICATED IN BOTH DOCUMENTS. WHERE DOCUMENTS CONFLICT WITHIN THEMSELVES OR WITH CODES AND REGULATIONS, PROVIDE THE HIGHER QUANTITY AND QUALITY AND FOLLOW THE STRICTER REQUIREMENTS.
- WORK AT A MINIMUM SHALL BE IN ACCORDANCE WITH OSHA, NFPA STANDARDS, THE ELECTRICAL CODE AND THE LOCAL GOVERNING AUTHORITIES. THE DRAWINGS AND SPECIFICATIONS DO NOT ATTEMPT TO INDICATE ALL WORK REQUIRED BY CODE AND AUTHORITIES. DO NOT INSTALL WORK THAT DOES NOT MEET THE MINIMUM REQUIREMENTS. IF NECESSARY, REQUEST CLARIFICATION FROM ARCHITECT AND ENGINEER BEFORE PROCEEDING.
- ALL EQUIPMENT SHALL BE INSTALLED IN A NEAT AND PROFESSIONAL MANNER. RECTILINEAR TO BUILDING STRUCTURE.
- IT IS THE INTENT OF THESE PLANS AND SPECIFICATIONS TO PROVIDE A WORKING INSTALLATION IN EVERY DETAIL AND ALL ITEMS REQUIRED FOR SUCH AN INSTALLATION SHALL BE PROVIDED WHETHER OR NOT SPECIFICALLY INDICATED OR MENTIONED.
- VISIT THE SITE TO DETERMINE PRE-EXISTING CONDITIONS AND WORK NECESSARY PRIOR TO SUBMISSION OF BID PRICE. SUBMIT ANY QUESTIONS REQUIRED TO CLARIFY SCOPE PRIOR TO BID. INCLUDE ALL REQUIRED WORK IN BID PRICE.
- INCLUDE IN BID WHATEVER IS REQUIRED TO MEET SCHEDULE INCLUDING OVERTIME, EXPRESS SHIPPING, EXPEDITING EQUIPMENT, ETC. PLAN FOR PROJECT AND SUBMIT SHOP DRAWING AND ORDER EQUIPMENT IN A TIMELY MANNER; EQUIPMENT SHALL BE BASED ON THE SPECIFIED EQUIPMENT.
- ANY EQUIPMENT TO BE SUBSTITUTED SHALL BE IDENTIFIED AT THE TIME OF BID. REFER TO SPECIFICATIONS FOR ADDITIONAL REQUIREMENTS FOR SUBSTITUTIONS.
- ALL ELECTRICAL DEVICES, WHEN INSTALLED, SHALL BE PROTECTED FROM DAMAGE DURING CONSTRUCTION. COVER PLATES SHALL BE INSTALLED AFTER FINISH MATERIALS HAVE BEEN APPLIED.
- TEST ALL EQUIPMENT AND SYSTEMS INSTALLED TO CERTIFY COMPLIANCE WITH DRAWINGS, SPECIFICATIONS, CODES, LOCAL AUTHORITIES AND REGULATIONS. INCLUDE LABOR AND COSTS FOR TESTING, REVIEWS, COMMISSIONING, APPROVALS AND CERTIFICATIONS.
- PROVIDE TRAINING TO OWNER ON ALL EQUIPMENT AND SYSTEMS INSTALLED.
- ALL CUTTING AND PATCHING REQUIRED FOR INSTALLING THE ELECTRICAL WORK SHALL BE FURNISHED AND INSTALLED BY THE CONTRACTOR. ALL CUTTING SHALL BE PATCHED AND FINISHED TO MATCH SURROUNDING AREA AND SATISFACTORY TO THE OWNER.

D3 GENERAL NOTES

C5 GENERAL PROJECT NOTES

- UNLESS NOTED OTHERWISE, THE SPACES THROUGHOUT INCORPORATE 2"x4" SUSPENDED ACOUSTICAL TILE CEILINGS WITH CLIP FASTENERS. THE CONTRACTOR SHALL BE RESPONSIBLE FOR REMOVING AND REINSTALLING THE TILES AS REQUIRED TO COMPLETED THE INSTALLATION OF NEW DEVICES AS SHOWN. IN THE EVENT THAT TILE SHOULD BE DAMAGED IN THE PROCESS, IMMEDIATELY NOTIFY RIVERVIEW PSYCHIATRIC CENTER (RPC) TO COORDINATE REPLACEMENT IN KIND.
- REFER TO THE PROJECT SPECIFICATION SECTION 011000-SUMMARY OF WORK FOR PHASING GENERAL REQUIREMENTS AND PROJECT COORDINATION.
- THE CONTRACTOR SHALL BE RESPONSIBLE FOR ALL REQUIRED ELECTRICAL POWER ASSOCIATED WITH THE INSTALLATION OF THE SYSTEMS AS SPECIFIED HEREIN.

A3	SECURITY LEGEND
----	-----------------

INSTALLATION COORDINATION NOTES

- DISCONNECT, REMOVE, RELOCATE, AND RECONNECT ELECTRICAL CONDUIT, WIRING, DEVICES, BOXES, FIXTURES, EQUIPMENT, ETC. AS INDICATED AND AS REQUIRED TO FACILITATE THE WORK OF DIVISION 26 AND OTHER DIVISIONS. THESE DRAWINGS ARE NOT INTENDED TO INDICATE ALL ITEMS TO BE REMOVED.
- THE LOCATION OF EQUIPMENT, OUTLETS, ETC. AS GIVEN ON THE DRAWINGS IS APPROXIMATE. IT SHALL BE UNDERSTOOD THAT THESE LOCATIONS ARE SUBJECT TO MODIFICATION AS MAY BE FOUND NECESSARY OR DESIRABLE AT THE TIME OF INSTALLATION IN ORDER TO MEET PROJECT REQUIREMENTS. SUCH CHANGES SHALL BE MADE WITHOUT EXTRA CHARGE.
- IF EXACT LOCATION, MOUNTING OR RACEWAY ROUTING ARE NOT INDICATED OR ARE NOT CLEAR OR CONFLICT (LOCATION OR HEIGHT) COORDINATE WITH OTHER TRADES AND REQUEST CLARIFICATION PRIOR TO ROUGH-IN OR INSTALLATION. DRAWINGS ARE DIAGRAMMATIC ONLY. EXACT LOCATION, MOUNTING HEIGHTS OR EQUIPMENT AND ROUTING OF RACEWAYS SHALL BE COORDINATED WITH THE EQUIPMENT REQUIREMENTS AND FIELD CONDITIONS.
- WHERE LOADS ARE ADDED TO EXISTING BRANCH CIRCUITS, VERIFY THAT THE EXISTING CIRCUITS HAVE ADEQUATE CAPACITY TO SUPPORT THE ADDITIONAL LOAD WITHOUT EXCEEDING SPECIFIED MAXIMUM LOAD.
- UNLESS OTHERWISE DIRECTED, PROVIDE ALL NEW POWER DISTRIBUTION EQUIPMENT WITH AIC RATINGS THAT MATCH OR EXCEED THE AIC RATING OF THE NEXT ACTIVE EXISTING UPSTREAM OVER-CURRENT PROTECTIVE DEVICE SERVING THE PANEL WHEN SERVED DIRECTLY BY ITS SOURCE (E.G. NO TRANSFORMER) OR PROVIDE AIC RATING THAT EXCEEDS BY 10% THE MAXIMUM LET THROUGH FAULT CURRENT (UNDER INFINITE PRIMARY BUSS) OF THE NEXT ACTIVE UPSTREAM TRANSFORMER (EXISTING OR NEW) SERVING THE RESPECTIVE PANEL.
- ALL NEW PANELS SHALL BE FULLY RATED FOR THE DESIGNATED AIC VALUE; PANELS UTILIZING SERIES RATINGS WILL NOT BE ACCEPTABLE. NEW CIRCUIT BREAKERS PROVIDED IN EXISTING PANELS SHALL BE PROVIDED WITH AIC RATINGS THAT MATCH OR EXCEED THE HIGHEST RATED OVER-CURRENT PROTECTIVE DEVICE WITHIN THE RESPECTIVE EXISTING PANEL.

A7	ELECTRICAL REMOVALS NOTES
----	---------------------------

WIRING NOTES

- UNLESS OTHERWISE INDICATED ON PLANS OR IN SPECIFICATIONS; ALL POWER DISTRIBUTION EQUIPMENT BISSING AND TRANSFORMER WINDINGS SHALL BE FABRICATED OF 98% CONDUCTIVE COPPER MATERIAL.
- UNLESS OTHERWISE INDICATED ON PLANS OR IN SPECIFICATIONS; ALL CONDUCTORS, SHALL BE FABRICATED OF 98% CONDUCTIVE COPPER MATERIAL. MINIMUM CONDUCTOR SIZE SHALL BE #12 AWG FOR BRANCH CIRCUITS AND #14 AWG FOR CONTROL WIRING.
- WIRING IS INDICATED ON DRAWINGS ONLY FOR SPECIFIC ROUTES OR SPECIAL CONDITIONS.
- BRANCH CIRCUIT WIRING NOT SHOWN. CIRCUITING SHALL IN ACCORDANCE WITH APPLICABLE CODES AND STANDARD PRACTICE. PROVIDE A 20A, 1P CIRCUIT BREAKER FOR EACH LIGHTING AND RECEPTACLE CIRCUIT UNLESS OTHERWISE INDICATED OR NOTED. CONNECT NO MORE THAN SIX DUPLEX CONVENIENCE RECEPTACLES PER BRANCH CIRCUIT. CONNECTED LOAD ON LIGHTING CIRCUITS SHALL NOT EXCEED 12 AMPS.
- ALL WIRING SHALL BE RUN CONCEALED UNLESS SPECIFIED OTHERWISE. ALL EXPOSED WIRING INCLUDING THAT WHICH IS INSTALLED ABOVE BUT IS VISIBLE FROM BELOW, PARTIALLY OR FULLY OPEN CEILING, SHALL BE INSTALLED IN CONDUIT OR RACEWAYS. REFER TO SPECIFICATIONS FOR ACCEPTABLE WIRING METHODS.
- A SEPARATE GROUNDING CONDUCTOR SHALL BE RUN IN EVERY FEEDER AND BRANCH CIRCUIT CONDUIT.
- MARK ALL CONDUITS AND JUNCTION BOXES WITH PERMANENT MARKER INDICATING PANEL AND CIRCUIT NUMBER OF CONDUCTORS CONTAINED WITHIN. LABEL WHERE CONDUITS ENTER PANELS, WIRE WAYS, PULL BOXES, ETC. LABEL EMPTY CONDUITS WITH SYSTEM (VOICE, DATA, SECURITY, ETC.) AND SOURCE OF CONDUIT.
- COORDINATE WITH OWNER TO DETERMINE WHICH RECEPTACLES AND ITEMS OF EQUIPMENT REQUIRE STANDBY GENERATOR POWER.
- ELECTRICAL WORK NOT SERVING STAIRWELLS SHALL NOT PASS THROUGH A STAIR ENCLOSURE UNLESS AN APPROVED RATED SOFFIT IS PROVIDED TO MAINTAIN FIRE AND SMOKE RATING.
- ALL RACEWAYS CROSSING EXPANSION JOINTS SHALL BE EQUIPPED WITH EXPANSION FITTINGS.
- PROVIDE NRTL LISTED SMOKE AND FIRE SEALS AT ALL PENETRATIONS THROUGH FLOORS OR FULL HEIGHT (FLOOR TO FLOOR) WALLS.

- REFER TO FLOOR PLANS FOR SCOPE OF WORK AREA.
- DASHED LINES REPRESENT WALLS SCHEDULED FOR REMOVAL; SOLID LINES REPRESENT WALLS REMAINING OR NEW WALLS.
- REFER TO LEGEND FOR DEFINITION OF (E), (R), (ER) AND (RL) TAGS.
- REFER TO NEW CONDITIONS PLANS FOR PROPOSED LOCATIONS OF ANY DEVICES/EQUIPMENT SCHEDULE FOR RELOCATION. PROVIDE REQUIRED SUPPORT COMPONENTS FOR INSTALLATION AT NEW LOCATION. EXTEND CONDUIT AND WIRE FROM EXISTING SOURCE OR LAST MAINTAINED ACTIVE DEVICE TO THE NEW LOCATION AND RE-TERMINATE TO DEVICE/EQUIPMENT.
- DISCONNECT AND REMOVE ALL ELECTRICAL DEVICES/EQUIPMENT LOCATED ON WALLS SCHEDULED FOR REMOVAL (E.G. LIGHTING, RECEPTACLES, CONTROL DEVICES, SWITCHES, POWER DISTRIBUTION EQUIPMENT, FIRE ALARM DEVICES, COMMUNICATION AND DATA DEVICES, ETC.) UNLESS OTHERWISE SPECIFICALLY NOTED ON THE PLANS.
- DISCONNECT AND REMOVE ALL WIRING FOR EQUIPMENT, SCHEDULED TO BE REMOVED, BACK TO THE POINT OF CONNECTION OR THE NEXT ACTIVE DEVICE SCHEDULED TO REMAIN. NOTHING SHALL BE ABANDONED IN PLACE.
- VERIFY ALL EXISTING SOURCES OF POWER TO DEVICES/EQUIPMENT PRIOR TO FINAL REMOVAL.
- COORDINATE ALL SHUTDOWN PROCEDURES WITH THE OWNER PRIOR TO DISCONNECTING ANY CIRCUITS.
- ALL DEVICES AND EQUIPMENT LOCATED ON WALLS SCHEDULED TO REMAIN SHALL BE MAINTAINED; RE-CIRCUIT THESE DEVICES/EQUIPMENT AS NECESSARY.
- WHERE ANY WALL OR SYSTEM COMPONENT REMOVALS IMPACT WIRING TO EXISTING DEVICES/EQUIPMENT SCHEDULED TO REMAIN, PROVIDE WIRING AND CONNECTIONS AS REQUIRED TO RE-FEED THESE DEVICES/EQUIPMENT.
- PROVIDE BLANK COVER PLATES FOR REMOVED POWER AND COMMUNICATIONS OUTLETS IN EXISTING WALLS THAT ARE SCHEDULED TO REMAIN.
- THE WORK INCLUDES DISPOSAL OF ALL REMOVED ELECTRICAL DEVICES/EQUIPMENT/CONDUIT/WIRING/BOXES INCLUDING BALLASTS, DRIVERS, LAMPS, THERMOSTATS, ETC. LEGALLY DISPOSE OF ALL HAZARDOUS MATERIALS. COORDINATE WITH THE OWNER TO RECEIVE DIRECTION FOR ANY REMOVED DEVICES/EQUIPMENT THAT THE OWNER WOULD LIKE TO RETAIN; CAREFULLY DISCONNECT AND REMOVED THEM THEN RELOCATE THEM TO A LOCATION ON SITE DESIGNATED BY THE OWNER.
- THE ELECTRICAL DEMOLITION FLOOR PLANS REPRESENT THE GENERAL SCOPE AND ARE NOT INTENDED TO SHOW ALL EXISTING EQUIPMENT, WIRING, CONDUITS, BOXES, DEVICES, OR FIXTURES. SURVEY THE WORK AREA AND VERIFY/IDENTIFY IN FIELD ALL DEVICES/EQUIPMENT AND RELATED COMPONENTS PLANNED FOR REMOVAL. COORDINATE WITH OWNER, ARCHITECT OR ENGINEER FOR DEMOLITION SCOPE CLARIFICATION AS NEEDED PRIOR TO REMOVING ITEMS IN QUESTION.
- COORDINATE, IN FIELD, WITH OTHER TRADES AND THEIR SYSTEM COMPONENTS SCHEDULED FOR REMOVAL TO ENSURE ANY RELATED POWER HAS BEEN PROPERLY DISCONNECTED, REMOVED AND MADE SAFE PRIOR TO THEIR RELATED DEMOLITION SCOPE.
- LIGHTING REMOVALS INCLUDE, BUT ARE NOT LIMITED TO INTERIOR LINEAR FIXTURES AND EXTERIOR WALL MOUNTED FIXTURES AS WELL AS THEIR RELATED CONTROL DEVICES AND WIRING.
- PROVIDE UPDATED PANEL DIRECTORIES INDICATING NEW LOADS AND SPARES FOR LOADS THAT HAVE BEEN REMOVED. TURN TO THE OFF POSITION ANY CIRCUIT BREAKERS THAT ARE NOT CONNECTED TO A LOAD. PROVIDE PLUGS IN EXISTING PANEL ENCLOSURES WHERE OPENINGS HAVE BEEN LEFT DUE TO REMOVED CONDUITS OR WIRING AND PROVIDE BLANKING PLATES IN PANELS WHERE BREAKERS HAVE BEEN REMOVED OR DO NOT EXIST.

SYSTEM POWER WIRING NOTES

- ALL VIDEO PROJECTOR, CAMERA AND MONITOR POWER OUTLETS AND THEIR ASSOCIATED COMPUTER POWER OUTLETS FEEDING THE VIDEO SOURCE ARE TO BE CONNECTED TO THE SAME PHASE TO ELIMINATE THE POTENTIAL FOR VIDEO INTERFERENCE BETWEEN VIDEO SOURCE AND EQUIPMENT. COORDINATE ALL POWER WIRING FOR SYSTEM EQUIPMENT WITH THE SYSTEM INSTALLER PRIOR TO INSTALLATION.

MOUNTING NOTES

- DO NOT SCALE THE DRAWINGS. REFER TO ARCHITECTURAL DRAWINGS AND EXISTING CONDITIONS FOR EXACT DIMENSIONS.
- IF THE DEVICE LOCATION IS NOT SPECIFICALLY SHOWN ON DRAWINGS, FOLLOW THE GUIDELINES LISTED BELOW:
- INSTALL NEARBY DEVICES ON ONE COMMON VERTICAL CENTERLINE
- INSTALL ADJACENT TO DEVICES LINED UP WITH A COMMON BOTTOM LINE.
- INSTALL DEVICES AT INDICATED HEIGHT AS APPLICABLE UNLESS OTHERWISE NOTED. ALL MOUNTING HEIGHTS SHALL BE MEASURED FROM FINISHED FLOOR TO CENTERLINE OF DEVICE EXCEPT AS INDICATED BY NOTE 7.
- ON MASONRY WALLS LINE UP THE BOTTOM OF THE DEVICE WITH A MASONRY JOINT AS CLOSE TO THE INDICATED HEIGHT AS PRACTICAL.
- INSTALL DEVICES IN SAME AREA AT THE SAME HEIGHT.
- MOUNT PANELS SIX FEET TO THE TOP OF THE PANEL OR ANNUNCIATOR/ FA GRAPHIC.
- MOUNT AT 8 FOOT TO BOTTOM FOR SIGNAGE, EMERGENCY LIGHTING, CLOCKS, SECURITY SENSORS, WALL MOUNTED OCCUPANCY SENSORS MODIFIED AS FOLLOWS: 4' FROM TOP OF DEVICE TO CEILING AND 4' ABOVE DOOR FRAMES.
- LOCATE CONTROL DEVICE AT LEAST 18" FROM AN INSIDE CORNER.
- SUPPORT WORK FROM THE BUILDING STRUCTURE.
- IN FINISHED AREAS ELECTRICAL WORK SHALL BE INSTALLED CONCEALED, RECESSED INTO WALLS OR INSTALLED ABOVE HUNG CEILINGS UNLESS OTHERWISE INDICATED.

A1	ABBREVIATIONS
----	---------------

160 Veranda Street
Portland, Maine 04103
T: 207.221.2260
F: 207.221.2266
Web: www.allied-eng.com

Allied Engineering
Structural Mechanical Electrical Commissioning

REVISIONS		DATE	BY	DESCRIPTION
1	11/21/23	PMC	ADDENELUM #1	

ABBREVIATIONS AND NOTES

RIVERVIEW SECURITY AND ACCESS CONTROLS
250 ARSENAL STREET, AUGUSTA, ME
© COPYRIGHT 2021 ALLIED ENGINEERING, INC.

E-000

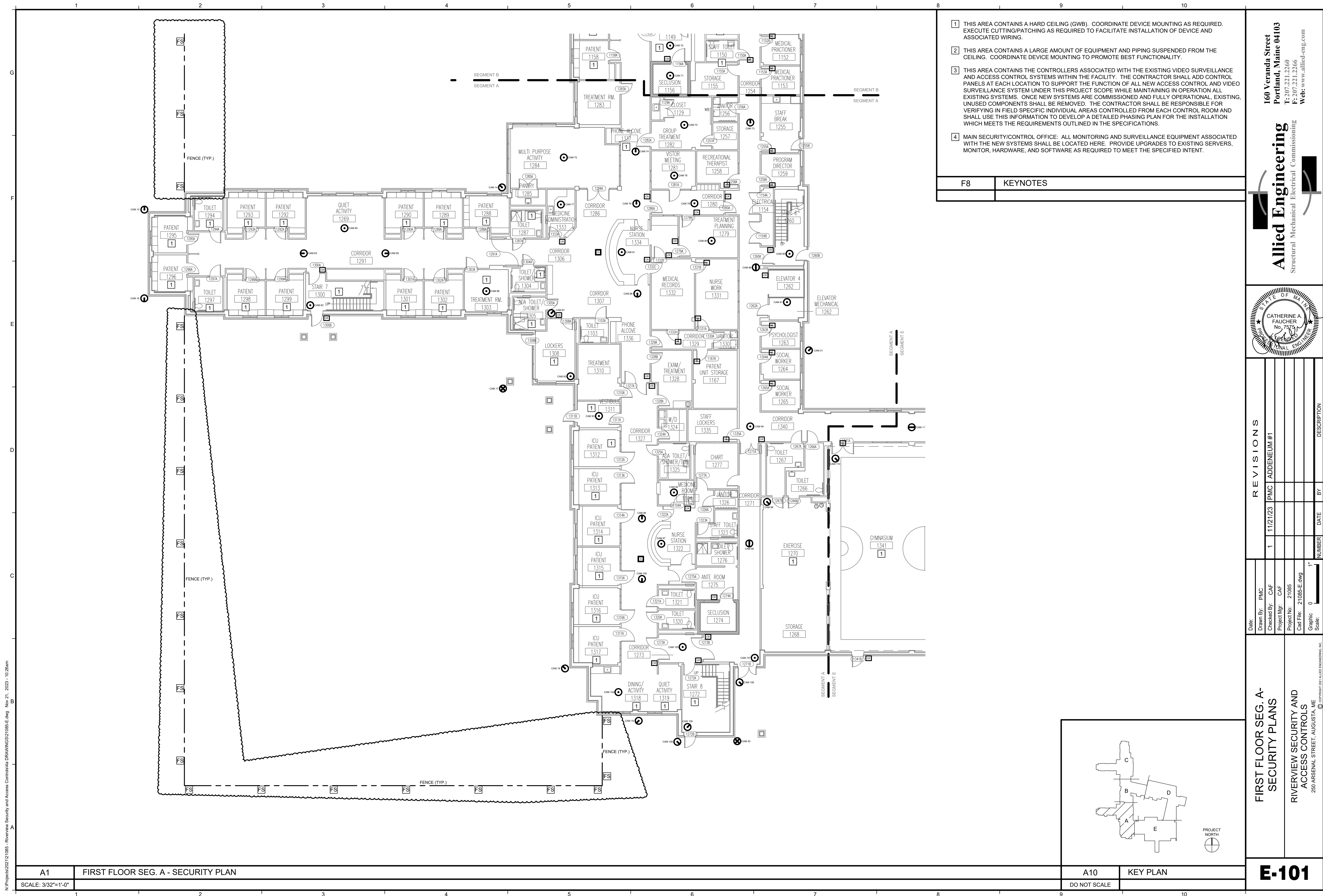

- 1 THIS AREA CONTAINS A HARD CEILING (GWB). COORDINATE DEVICE MOUNTING AS REQUIRED. EXECUTE CUTTING/PATCHING AS REQUIRED TO FACILITATE INSTALLATION OF DEVICE AND ASSOCIATED WIRING.
- 2 THIS AREA CONTAINS A LARGE AMOUNT OF EQUIPMENT AND PIPING SUSPENDED FROM THE CEILING. COORDINATE DEVICE MOUNTING TO PROMOTE BEST FUNCTIONALITY.
- 3 THIS AREA CONTAINS THE CONTROLLERS ASSOCIATED WITH THE EXISTING VIDEO SURVEILLANCE AND ACCESS CONTROL SYSTEMS WITHIN THE FACILITY. THE CONTRACTOR SHALL ADD CONTROL PANELS AT EACH LOCATION TO SUPPORT THE FUNCTION OF ALL NEW ACCESS CONTROL AND VIDEO SURVEILLANCE SYSTEM UNDER THIS PROJECT SCOPE WHILE MAINTAINING IN OPERATION ALL EXISTING SYSTEMS. ONCE NEW SYSTEMS ARE COMMISSIONED AND FULLY OPERATIONAL, EXISTING UNUSED COMPONENTS SHALL BE REMOVED. THE CONTRACTOR SHALL BE RESPONSIBLE FOR VERIFYING IN FIELD SPECIFIC INDIVIDUAL AREAS CONTROLLED FROM EACH CONTROL ROOM AND SHALL USE THIS INFORMATION TO DEVELOP A DETAILED PHASING PLAN FOR THE INSTALLATION WHICH MEETS THE REQUIREMENTS OUTLINED IN THE SPECIFICATIONS.
- 4 MAIN SECURITY/CONTROL OFFICE: ALL MONITORING AND SURVEILLANCE EQUIPMENT ASSOCIATED WITH THE NEW SYSTEMS SHALL BE LOCATED HERE. PROVIDE UPGRADES TO EXISTING SERVERS, MONITOR, HARDWARE, AND SOFTWARE AS REQUIRED TO MEET THE SPECIFIED INTENT.

F8	KEYNOTES
----	----------

160 Veranda Street
 Portland, Maine 04103
 T: 207.221.2260
 F: 207.221.2266
 Web: www.allied-eng.com

Allied Engineering
 Structural Mechanical Electrical Commissioning

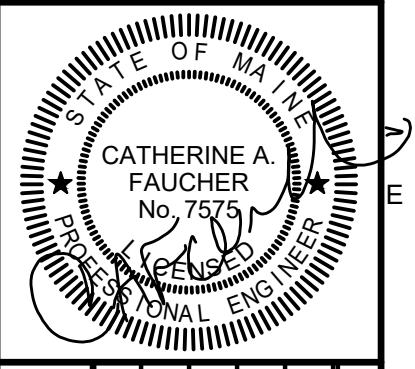

REVISIONS		DATE	BY	DESCRIPTION
1	11/21/23	PMC	ADDENDUM #1	

Date:	Drawn By:	Checked By:	Project Mgr.:	Cam File:	Graphic Scale:
	PMC	CAF	CAF	21085-E.dwg	0 1"

FIRST FLOOR SEG. A - SECURITY PLANS

RIVERVIEW SECURITY AND ACCESS CONTROLS
 250 ARSENAL STREET, AUGUSTA, ME
 © COPYRIGHT 2021 ALLIED ENGINEERING, INC.

E-101

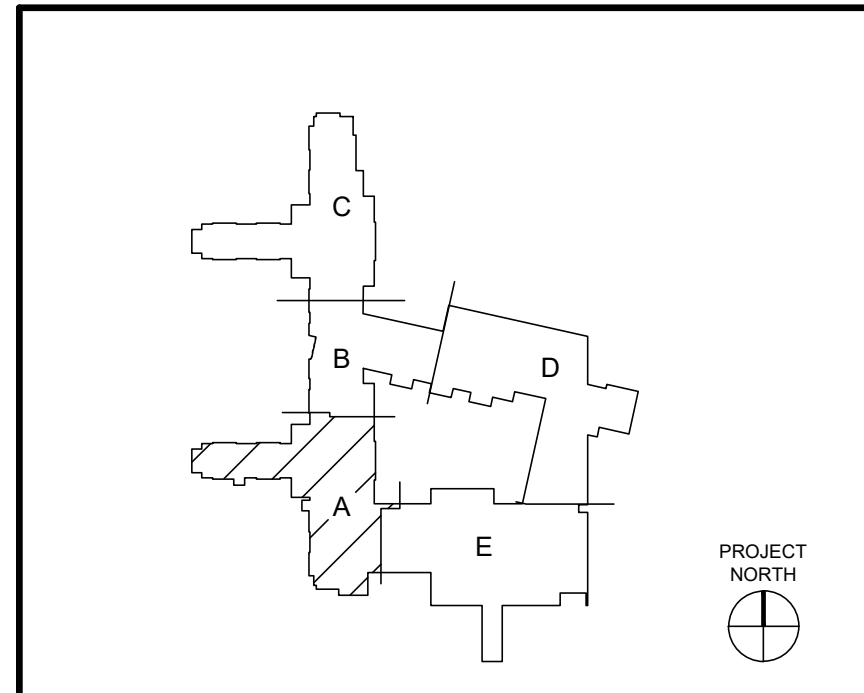

A1 FIRST FLOOR SEG. A - SECURITY PLAN
 SCALE: 3/32"=1'-0"

A10 KEY PLAN
 DO NOT SCALE

CONSTRUCTION DOCUMENTS - ISSUED FOR BID - 11-02-2023

N:\Projects\2023\21085 - Riverview Security and Access Controls\A1 DRAWING\321085-E.dwg Nov 21, 2023 - 10:26am



- 1 THIS AREA CONTAINS A HARD CEILING (GWB). COORDINATE DEVICE MOUNTING AS REQUIRED. EXECUTE CUTTING/PATCHING AS REQUIRED TO FACILITATE INSTALLATION OF DEVICE AND ASSOCIATED WIRING.
- 2 THIS AREA CONTAINS A LARGE AMOUNT OF EQUIPMENT AND PIPING SUSPENDED FROM THE CEILING. COORDINATE DEVICE MOUNTING TO PROMOTE BEST FUNCTIONALITY.
- 3 THIS AREA CONTAINS THE CONTROLLERS ASSOCIATED WITH THE EXISTING VIDEO SURVEILLANCE AND ACCESS CONTROL SYSTEMS WITHIN THE FACILITY. THE CONTRACTOR SHALL ADD CONTROL PANELS AT EACH LOCATION TO SUPPORT THE FUNCTION OF ALL NEW ACCESS CONTROL AND VIDEO SURVEILLANCE SYSTEM UNDER THIS PROJECT SCOPE WHILE MAINTAINING IN OPERATION ALL EXISTING SYSTEMS. ONCE NEW SYSTEMS ARE COMMISSIONED AND FULLY OPERATIONAL, EXISTING UNUSED COMPONENTS SHALL BE REMOVED. THE CONTRACTOR SHALL BE RESPONSIBLE FOR VERIFYING IN FIELD SPECIFIC INDIVIDUAL AREAS CONTROLLED FROM EACH CONTROL ROOM AND SHALL USE THIS INFORMATION TO DEVELOP A DETAILED PHASING PLAN FOR THE INSTALLATION WHICH MEETS THE REQUIREMENTS OUTLINED IN THE SPECIFICATIONS.
- 4 MAIN SECURITY/CONTROL OFFICE: ALL MONITORING AND SURVEILLANCE EQUIPMENT ASSOCIATED WITH THE NEW SYSTEMS SHALL BE LOCATED HERE. PROVIDE UPGRADES TO EXISTING SERVERS, MONITOR, HARDWARE, AND SOFTWARE AS REQUIRED TO MEET THE SPECIFIED INTENT.

F8	KEYNOTES
----	----------

160 Veranda Street
 Portland, Maine 04103
 T: 207.221.2260
 F: 207.221.2266
 Web: www.allied-eng.com

Allied Engineering
 Structural Mechanical Electrical Commissioning

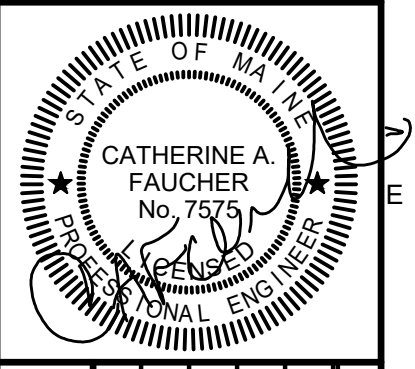

REVISIONS		DATE	BY	DESCRIPTION
1	11/21/23	PMC	ADDENDUM #1	

Date:	11/21/23
Drawn By:	PMC
Checked By:	CAF
Project Mgr.:	CAF
Project No.:	21085
Caf File:	21085-E.dwg
Graphic Scale:	1" = 0'

FIRST FLOOR SEG. B - SECURITY PLANS

RIVERVIEW SECURITY AND ACCESS CONTROLS
 250 ARSENAL STREET, AUGUSTA, ME
 © COPYRIGHT 2021 ALLIED ENGINEERING, INC.

E-102

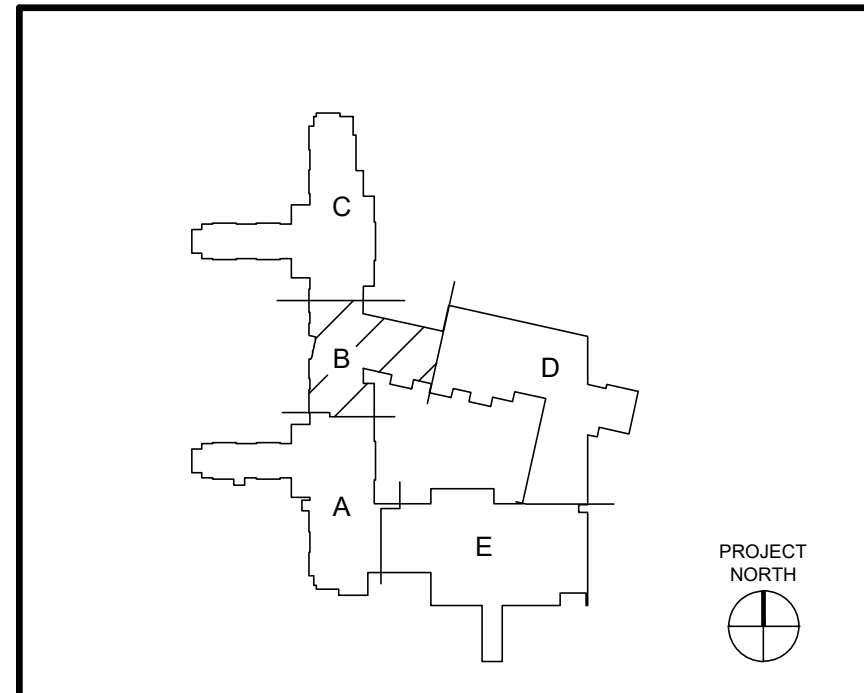

A1 FIRST FLOOR SEG. B - SECURITY PLAN
 SCALE: 3/32"=1'-0"

A10 KEY PLAN
 DO NOT SCALE

N:\Projects\2023\21085 - Riverview Security and Access Controls\4.dwg Nov 21, 2023 - 10:27am

CONSTRUCTION DOCUMENTS - ISSUED FOR BID - 11-02-2023

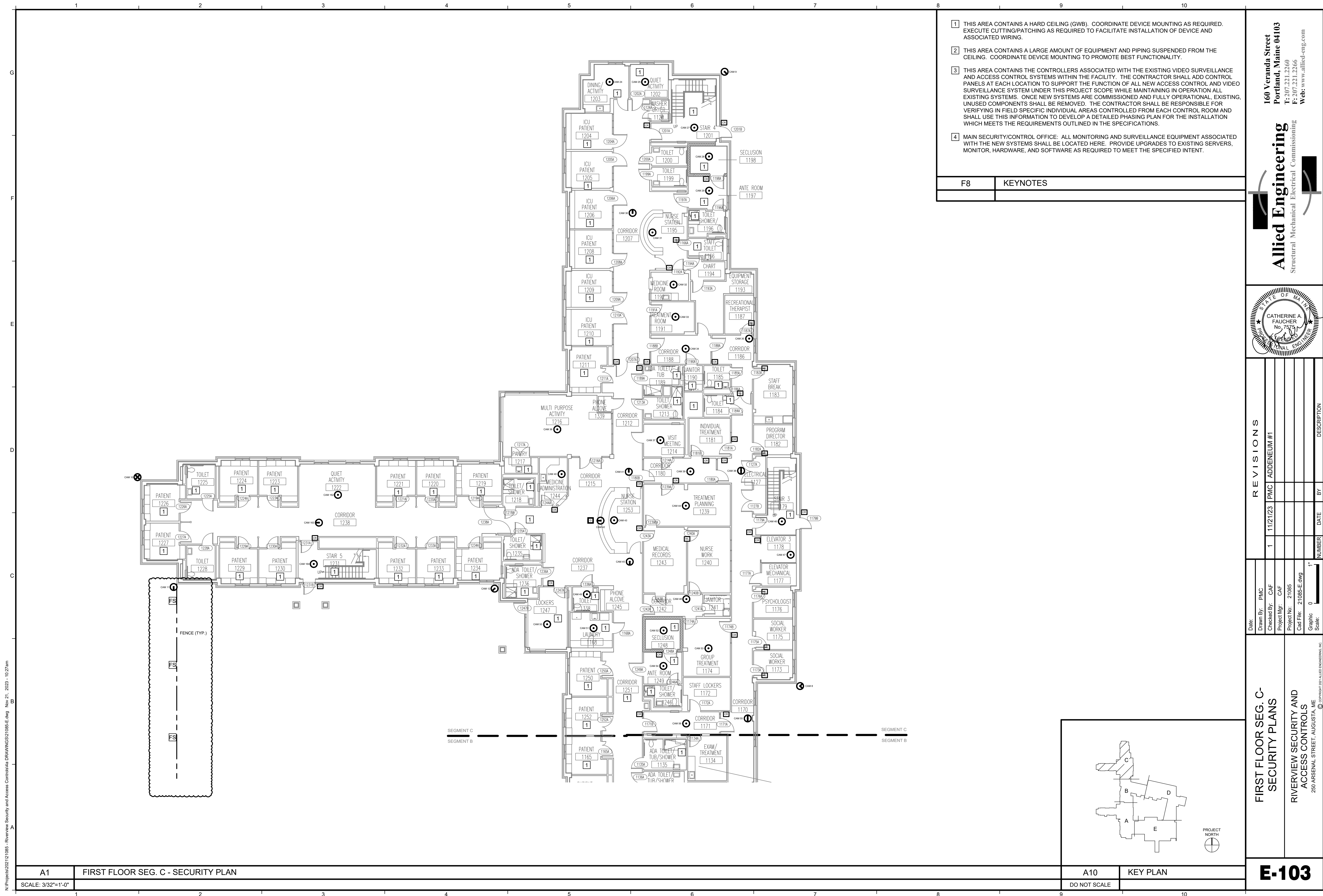

- 1 THIS AREA CONTAINS A HARD CEILING (GWB). COORDINATE DEVICE MOUNTING AS REQUIRED. EXECUTE CUTTING/PATCHING AS REQUIRED TO FACILITATE INSTALLATION OF DEVICE AND ASSOCIATED WIRING.
- 2 THIS AREA CONTAINS A LARGE AMOUNT OF EQUIPMENT AND PIPING SUSPENDED FROM THE CEILING. COORDINATE DEVICE MOUNTING TO PROMOTE BEST FUNCTIONALITY.
- 3 THIS AREA CONTAINS THE CONTROLLERS ASSOCIATED WITH THE EXISTING VIDEO SURVEILLANCE AND ACCESS CONTROL SYSTEMS WITHIN THE FACILITY. THE CONTRACTOR SHALL ADD CONTROL PANELS AT EACH LOCATION TO SUPPORT THE FUNCTION OF ALL NEW ACCESS CONTROL AND VIDEO SURVEILLANCE SYSTEM UNDER THIS PROJECT SCOPE WHILE MAINTAINING IN OPERATION ALL EXISTING SYSTEMS. ONCE NEW SYSTEMS ARE COMMISSIONED AND FULLY OPERATIONAL, EXISTING UNUSED COMPONENTS SHALL BE REMOVED. THE CONTRACTOR SHALL BE RESPONSIBLE FOR VERIFYING IN FIELD SPECIFIC INDIVIDUAL AREAS CONTROLLED FROM EACH CONTROL ROOM AND SHALL USE THIS INFORMATION TO DEVELOP A DETAILED PHASING PLAN FOR THE INSTALLATION WHICH MEETS THE REQUIREMENTS OUTLINED IN THE SPECIFICATIONS.
- 4 MAIN SECURITY/CONTROL OFFICE: ALL MONITORING AND SURVEILLANCE EQUIPMENT ASSOCIATED WITH THE NEW SYSTEMS SHALL BE LOCATED HERE. PROVIDE UPGRADES TO EXISTING SERVERS, MONITOR, HARDWARE, AND SOFTWARE AS REQUIRED TO MEET THE SPECIFIED INTENT.

F8	KEYNOTES
----	----------

160 Veranda Street
 Portland, Maine 04103
 T: 207.221.2260
 F: 207.221.2266
 Web: www.allied-eng.com

Allied Engineering
 Structural Mechanical Electrical Commissioning

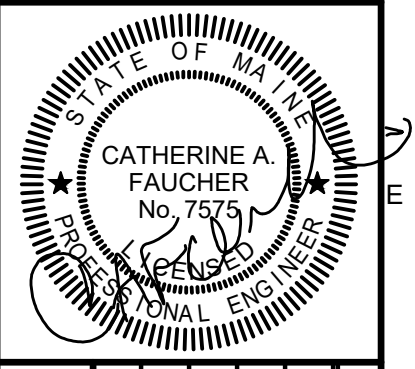

REVISIONS		DATE	BY	DESCRIPTION
1	11/21/23	PMC	ADDENDUM #1	

Date:	11/21/23
Drawn By:	PMC
Checked By:	CAF
Project Mgr.:	CAF
Project No.:	21085
CAF File:	21085-E.dwg
Graphic Scale:	0 1" = 10'

FIRST FLOOR SEG. C - SECURITY PLANS

RIVERVIEW SECURITY AND ACCESS CONTROLS
 250 ARSENAL STREET, AUGUSTA, ME
 © COPYRIGHT 2021 ALLIED ENGINEERING, INC.

E-103

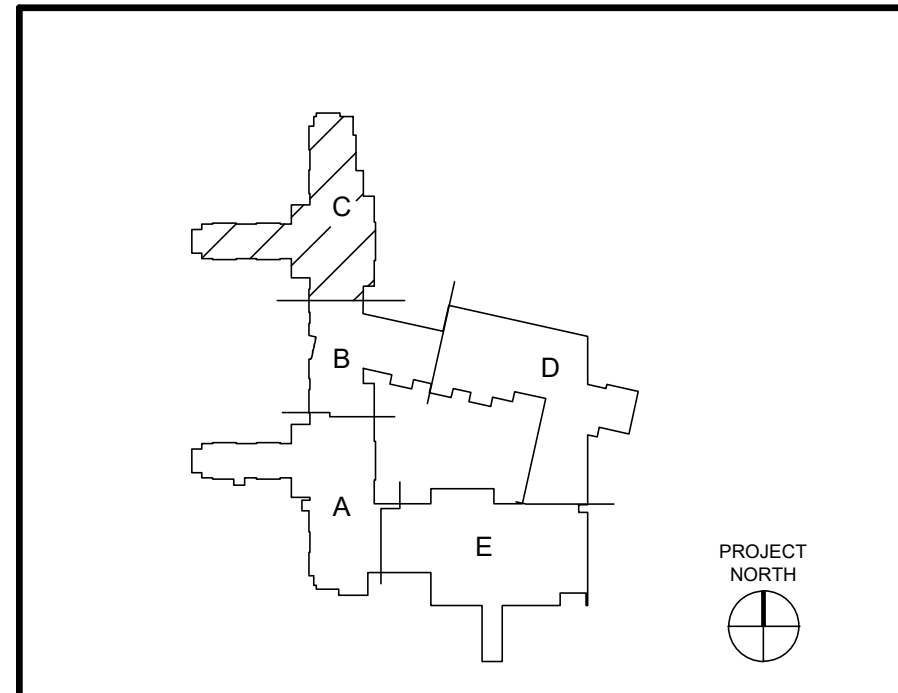

A10 KEY PLAN
 DO NOT SCALE

A1 FIRST FLOOR SEG. C - SECURITY PLAN
 SCALE: 3/32"=1'-0"

N:\Projects\2023\21085 - Riverview Security and Access Controls\A1 DRAWINGS\21085-E.dwg Nov 21, 2023 - 10:27am

CONSTRUCTION DOCUMENTS - ISSUED FOR BID - 11-02-2023