

# LONG CREEK YOUTH DEVELOPMENT CENTER PAVING

675 WESTBROOK STREET  
SOUTH PORTLAND, MAINE 04106

**APPLICANT:**  
MAINE DEPARTMENT OF  
CORRECTIONS  
SHS 111, 25 TYSON DRIVE  
AUGUSTA, MAINE 04333

**ENGINEER/SURVEYOR:**

**SEBAGO**  
TECHNICS  
WWW.SEBAGOTECHNICS.COM  
75 John Roberts Rd.  
Suite 4A  
South Portland, ME 04106  
Tel. 207-200-2100

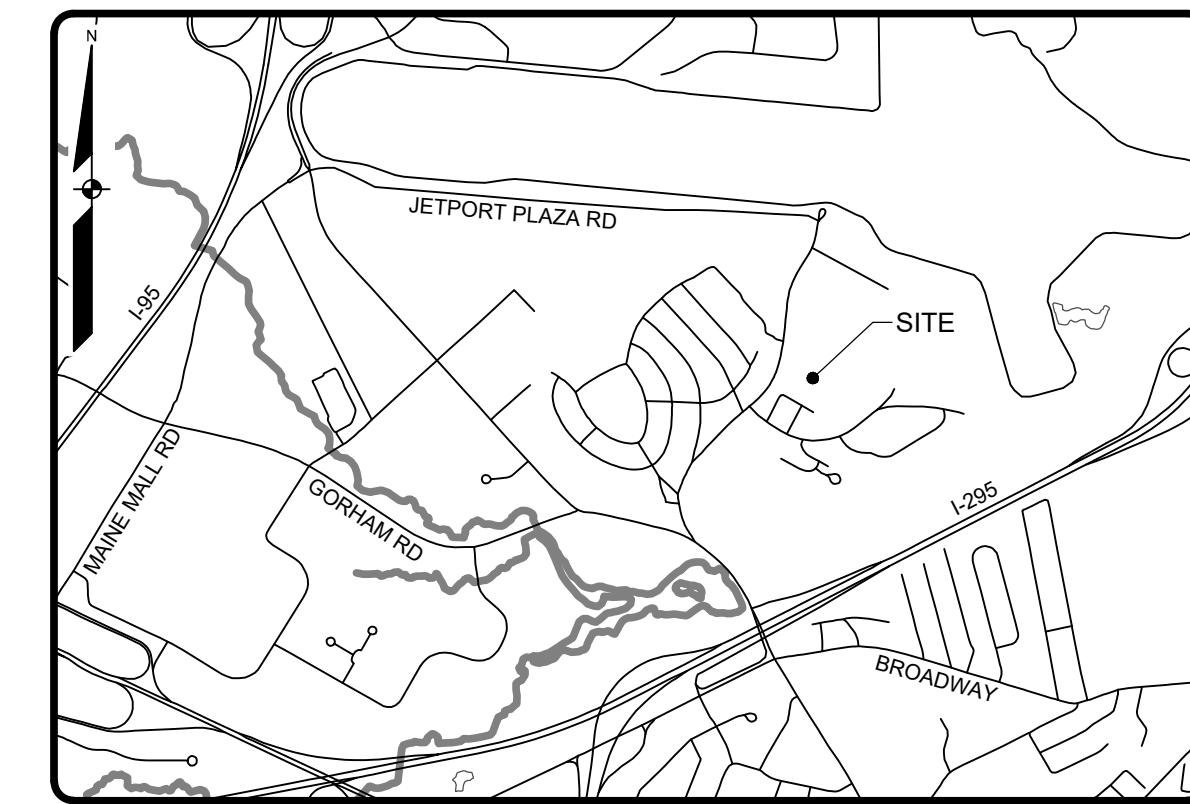
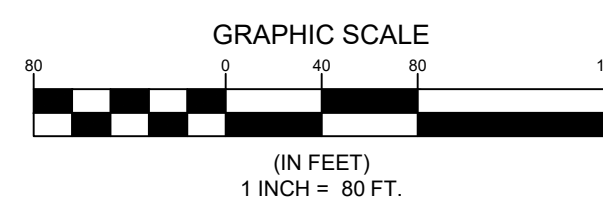
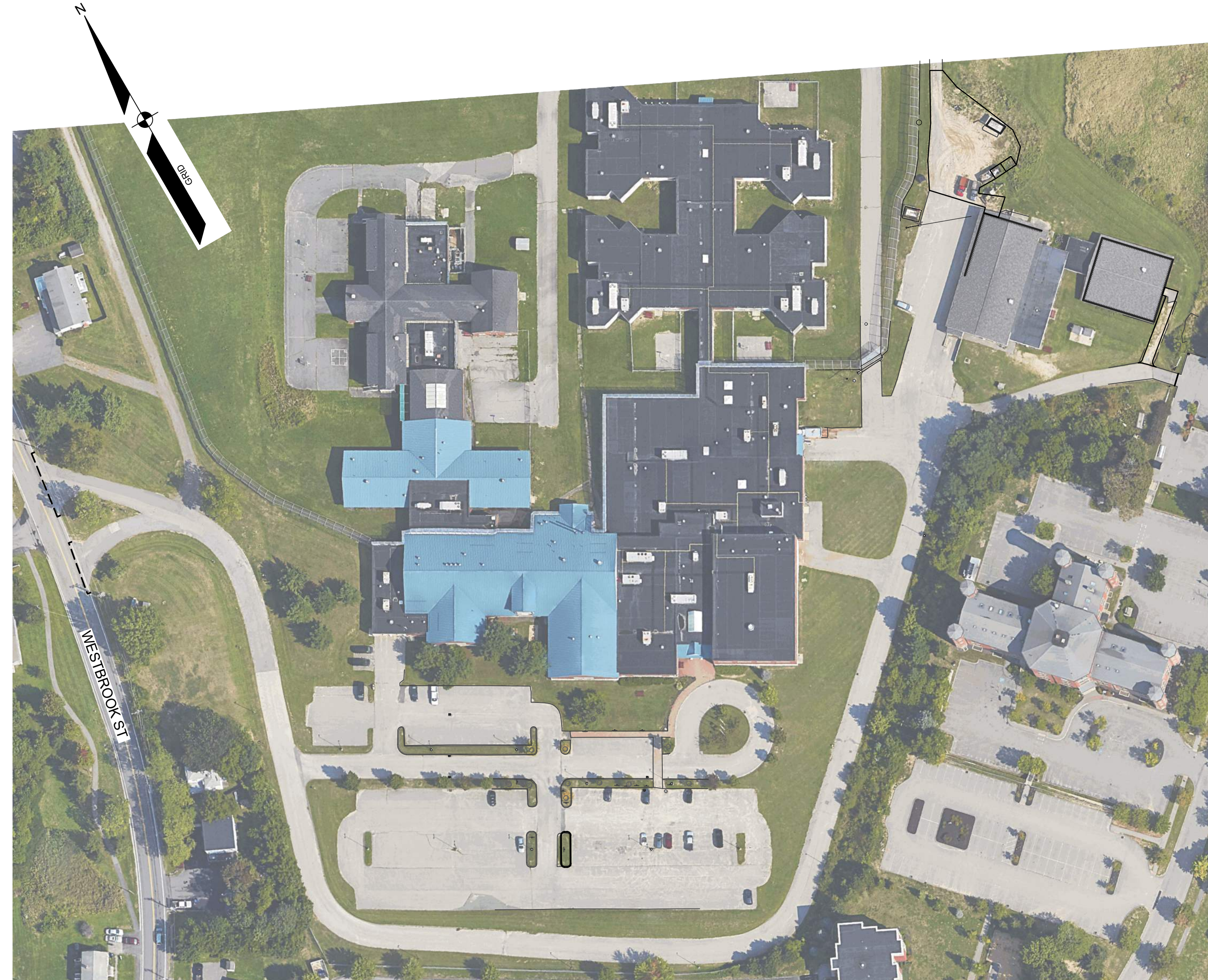

LOCATION MAP NTS

## Sheet List Table

SHEET	TITLE
1	COVER SHEET
2	NOTES & LEGEND
3	OVERALL GRADING & UTILITY PLAN
4	GRADING & UTILITY PLAN
5	GRADING & UTILITY PLAN
6	GRADING & UTILITY PLAN
7	EROSION CONTROL NOTES
8	EROSION CONTROL AND SITE DETAILS

NOT FOR CONSTRUCTION

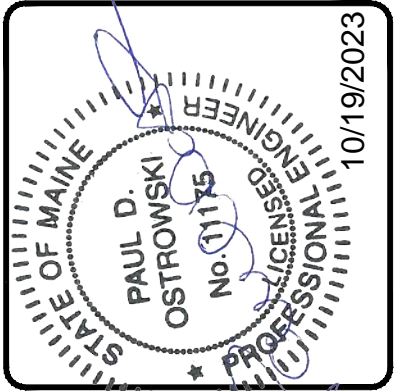

REV.	BY	DATE	STATUS	ISSUED FOR BIDDING
A		10/31/2023		

THIS PLAN SHALL NOT BE COPIED WITHOUT WRITTEN PERMISSION FROM SEBAGO TECHNICS, INC. ANY ALTERATIONS, AUTHORIZED OR OTHERWISE, SHALL BE AT THE USER'S SOLE RISK AND WITHOUT LIABILITY TO SEBAGO TECHNICS, INC.

**SEBAGO**  
TECHNICS  
WWW.SEBAGOTECHNICS.COM  
75 John Roberts Rd.  
Suite 4A  
South Portland, ME 04106  
Tel. 207-200-2100

COVER SHEET  
OF:  
LONG CREEK YOUTH DEVT. CENTER PAVING  
675 WESTBROOK STREET  
SOUTH PORTLAND, MAINE 04106  
FOR:  
MAINE DEPARTMENT OF CORRECTIONS  
SHS 111, 25 TYSON DRIVE  
AUGUSTA, MAINE 04333

DESIGNED	BJB
DRAWN	ABB
CHECKED	PDO
DATE	06/15/2023
SCALE	1" = 80'
PROJECT	230282



F:\Projects\2302282\2302282\DWG\Design\2302282\_OAG.dwg - 10/17/2023 9:25 AM - BRANDON ELANE



**LEGEND**

- BASE BID ITEMS
- ALTERNATE BID #1 ITEMS
- ALTERNATE BID #2 ITEMS
- ALTERNATE BID #3 ITEMS

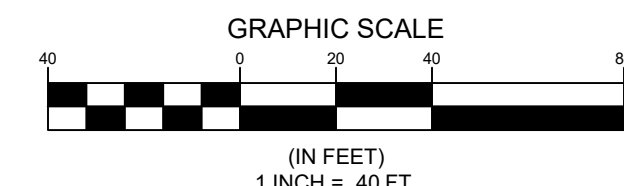

NOT FOR CONSTRUCTION

PAUL D. OSTROWSKI, P.E. 11175  
 STATE OF MAINE  
 PAUL D. OSTROWSKI  
 NO. 11175  
 PROFESSIONAL ENGINEER  
 EXPIRES 10/19/2023

REV.	BY	DATE	STATUS
A	PDO	10/31/2023	ISSUED FOR BIDDING

THIS PLAN SHALL NOT BE MODIFIED WITHOUT WRITTEN PERMISSION FROM SEBAGO TECHNICS, INC. ANY ALTERATIONS, AUTHORIZED OR OTHERWISE, SHALL BE AT THE USER'S SOLE RISK AND WITHOUT LIABILITY TO SEBAGO TECHNICS, INC.

**SEBAGO**  
 TECHNICS  
 WWW.SEAGOTECHNICS.COM  
 75 John Roberts Rd.  
 South Portland, ME 04106  
 Tel. 207-200-2100

**OVERALL GRADING & UTILITY PLAN**  
 OF:  
**LONG CREEK YOUTH DEVT. CENTER PAVING**  
 675 WESTBROOK STREET  
 SOUTH PORTLAND, MAINE 04106  
 FOR:  
**MAINE DEPARTMENT OF CORRECTIONS**  
 SHS 111, 25 TYSON DRIVE  
 AUGUSTA, MAINE 04333

DESIGNED	BJB
DRAWN	ABB
CHECKED	PDO
DATE	06/15/2023
SCALE	1" = 40'
PROJECT	2302282

**SHEET 3 OF 8**

2302282\_OAG.dwg - TAB-ONGU

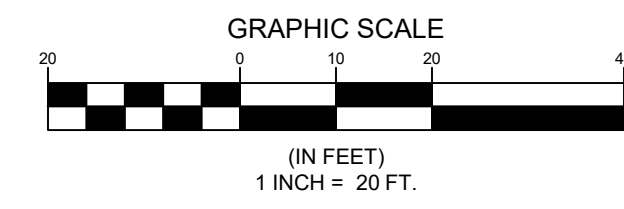
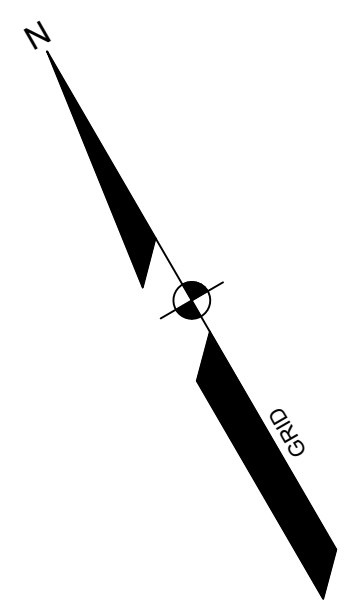

DESIGNED	BJB
DRAWN	ABB
CHECKED	PDO
DATE	06/15/2023
SCALE	1" = 20'
PROJECT	230282

**GRADING & UTILITY PLAN**  
 OF:  
**LONG CREEK YOUTH DEVT. CENTER PAVING**  
 675 WESTBROOK STREET  
 SOUTH PORTLAND, MAINE 04106  
 FOR:  
**MAINE DEPARTMENT OF CORRECTIONS**  
 SHS 111, 25 TYSON DRIVE  
 AUGUSTA, MAINE 04333

**SEBAGO**  
 TECHNICALS  
 WWW.SEAGOTECHNICALS.COM  
 75 John Roberts Rd.  
 South Portland, ME 04106  
 Tel. 207-200-2100

REV.	BY	DATE	STATUS	ISSUED FOR BIDDING
A		10/31/2023		

THIS PLAN SHALL NOT BE MODIFIED WITHOUT WRITTEN PERMISSION FROM SEBAGO TECHNICALS, INC. ANY ALTERATIONS, AUTHORIZED OR OTHERWISE, SHALL BE AT THE USER'S SOLE RISK AND WITHOUT LIABILITY TO SEBAGO TECHNICALS, INC.

PAUL D. OSTROWSKI, P.E. 11175  
 STATE OF MAINE  
 PROFESSIONAL ENGINEER  
 PAUL D. OSTROWSKI  
 NO. 11175  
 10/19/2023

**NOT FOR CONSTRUCTION**

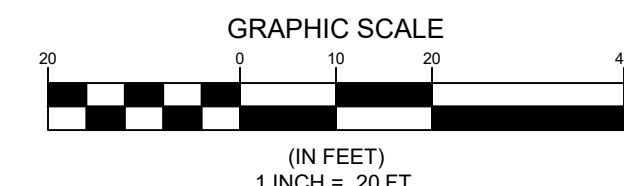

NOT FOR CONSTRUCTION

PAUL D. OSTROWSKI, P.E. 11175  
 STATE OF MAINE  
 PAUL D. OSTROWSKI  
 NO. 11175  
 PROFESSIONAL ENGINEER  
 LICENSE NO. 10191/2023

REV.	BY	DATE	ISSUED FOR BIDDING	STATUS
A	PDO	10/31/2023	ISSUED FOR BIDDING	

THIS PLAN SHALL NOT BE MODIFIED WITHOUT WRITTEN PERMISSION FROM SEBAGO TECHNICS, INC. ANY ALTERATIONS, AUTHORIZED OR OTHERWISE, SHALL BE AT THE USER'S SOLE RISK AND WITHOUT LIABILITY TO SEBAGO TECHNICS, INC.

**SEBAGO**  
 TECHNICS  
 WWW.SEBAGOTECHNICS.COM  
 75 John Roberts Rd.  
 South Portland, ME 04106  
 Tel. 207-200-2100

GRADING & UTILITY PLAN  
 OF:  
 LONG CREEK YOUTH DEVT. CENTER PAVING  
 675 WESTBROOK STREET  
 SOUTH PORTLAND, MAINE 04106  
 FOR:  
 MAINE DEPARTMENT OF CORRECTIONS  
 SHS 111, 25 TYSON DRIVE  
 AUGUSTA, MAINE 04333

DESIGNED	BJB
DRAWN	ABB
CHECKED	PDO
DATE	06/15/2023
SCALE	1" = 20'
PROJECT	2302282

SHEET 5 OF 8





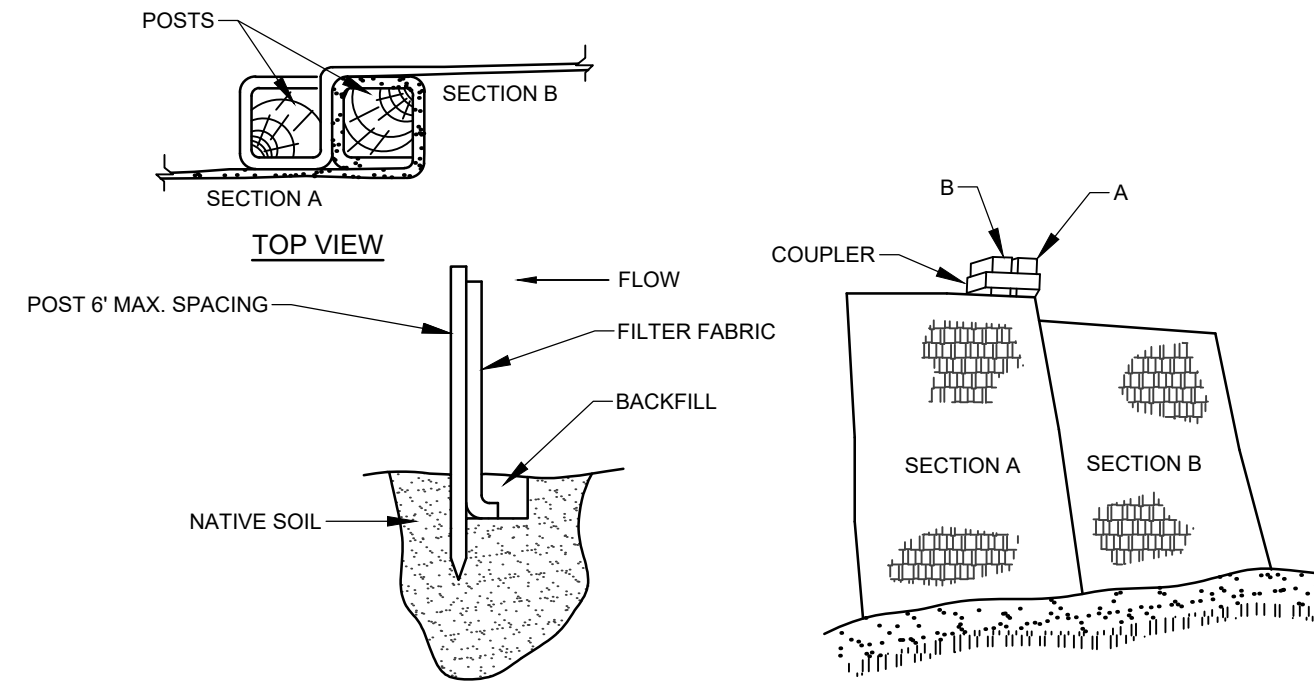

- INSTALLATION:**
- EXCAVATE A 6"x 6" TRENCH ALONG THE LINE OF PLACEMENT FOR THE FILTER BARRIER.
  - UNROLL A SECTION AT A TIME AND POSITION THE POSTS AGAINST THE BACK (DOWNSTREAM) WALL OF THE TRENCH.
  - DRIVE POSTS INTO THE GROUND UNTIL APPROXIMATELY 2" OF FABRIC IS LYING ON THE TRENCH BOTTOM.
  - LAY THE TOE-IN FLAP OF FABRIC ONTO THE UNDISTURBED BOTTOM OF THE TRENCH. BACKFILL THE TRENCH AND TAMP THE SOIL. TOE-IN CAN ALSO BE ACCOMPLISHED BY LAYING THE FABRIC FLAP ON UNDISTURBED GROUND AND PILING AND TAMPING FILL AT THE BASE, BUT MUST BE ACCOMPANIED BY AN INTERCEPTION DITCH.
  - JOIN SECTION AS SHOWN ABOVE.
  - BARRIER SHALL BE MIRAFI SILT FENCE OR EQUAL.

**FILTER BARRIER**  
NOT TO SCALE

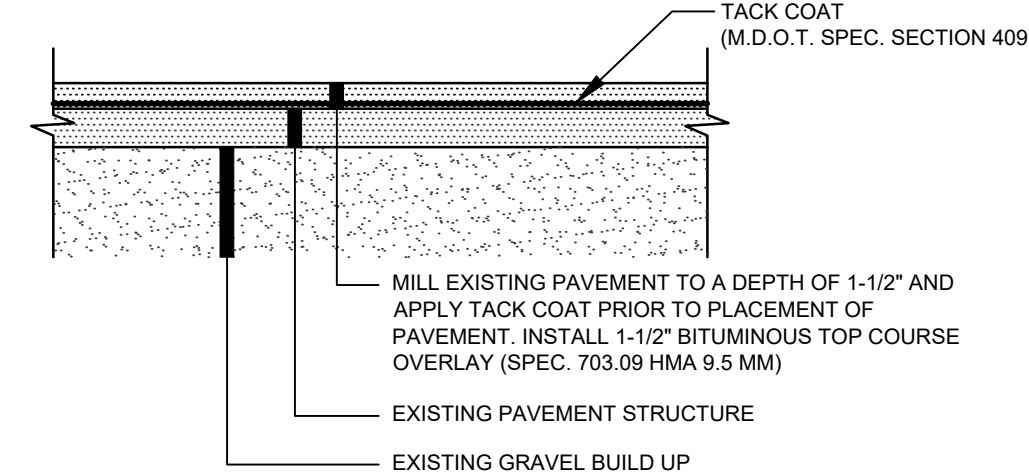

**PAVEMENT MILL AND OVERLAY SECTION**  
NOT TO SCALE

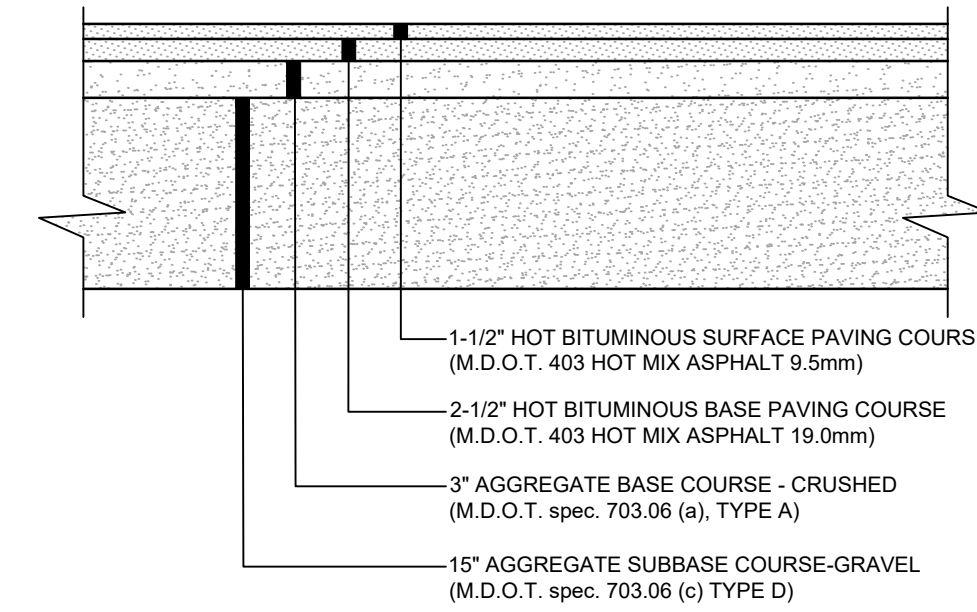

**FULL DEPTH PAVEMENT SECTION**  
NOT TO SCALE

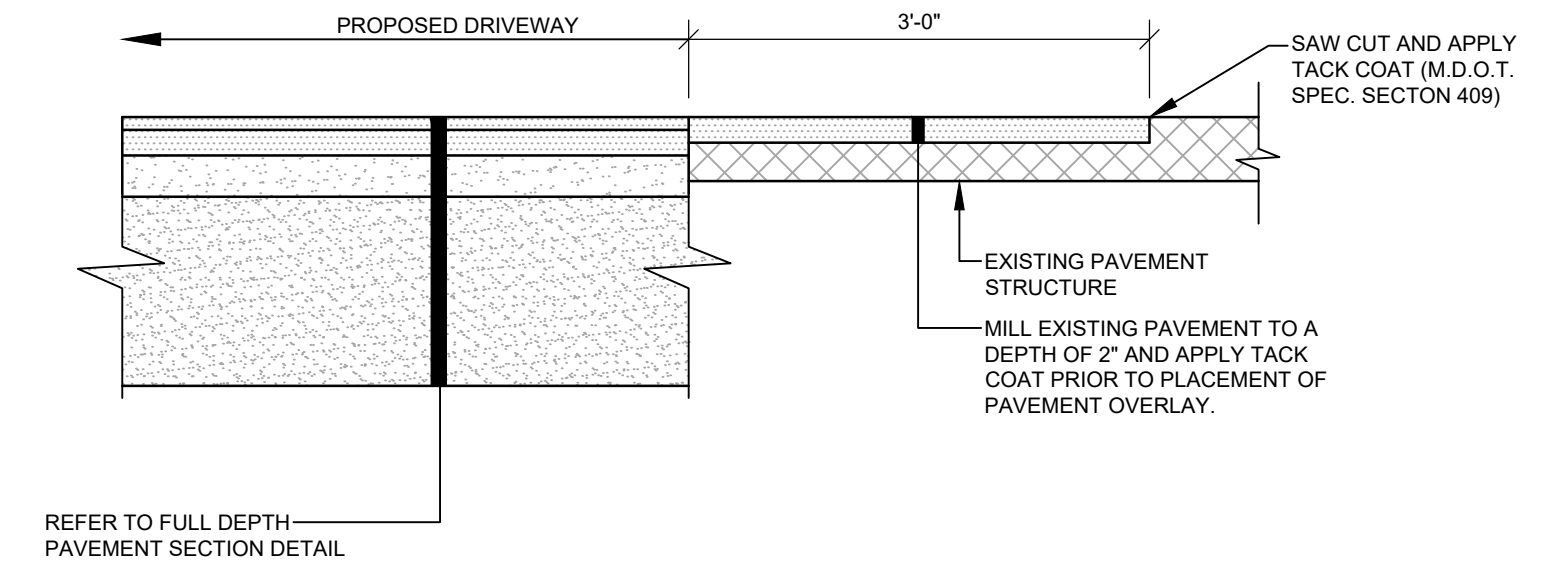

**PAVEMENT JOINT**  
NOT TO SCALE

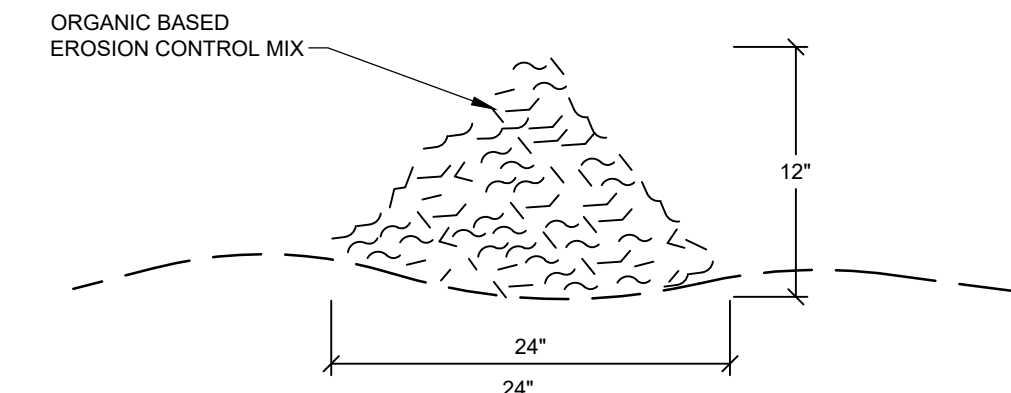

**COMPOSITION:**  
EROSION CONTROL MIX SHALL BE MANUFACTURED ON OR OFF THE PROJECT SITE SUCH THAT ITS COMPOSITION IS IN ACCORDANCE WITH THE MDEP MAINE EROSION AND SEDIMENT CONTROL BMP MANUAL, LAST REVISED 3/2003 OR LATER. IT MUST CONSIST PRIMARILY OF ORGANIC MATERIAL, SEPARATED AT THE POINT OF GENERATION, AND MAY INCLUDE: SHREDDED BARK, STUMP GRINDINGS, COMPOSTED BARK, OR ACCEPTABLE MANUFACTURED PRODUCTS, WOOD AND BARK CHIPS, GROUND CONSTRUCTION DEBRIS OR REPROCESSED WOOD PRODUCTS WILL NOT BE ACCEPTABLE AS THE ORGANIC COMPONENT OF THE MIX.

- INSTALLATION:**
- THE BARRIER MUST BE PLACED ACROSS THE SLOPE, ALONG THE CONTOUR.
  - EXISTING GROUND SHALL BE PREPARED SUCH THAT THE BARRIER MAY LIE NEARLY FLAT ALONG THE GROUND TO AVOID THE CREATION OF VOIDS AND BRIDGES IN ORDER TO MINIMIZE THE POTENTIAL OF WASH OUTS UNDER THE BARRIER.
  - THE BARRIER SHALL BE A MINIMUM OF 1 FOOT HIGH (AS MEASURED ON THE UPHILL SIDE) AND 2 FEET WIDE FOR SLOPES LESS THAN 5% IN GRADE AND SHALL BE WIDER TO ACCOMMODATE THE ADDITIONAL RUNOFF.
  - EROSION CONTROL MIX CAN BE INSTALLED WHERE SILT FENCE IS ILLUSTRATED ON THE DESIGN PLANS IN AREAS EXCEPT IN, BUT NOT LIMITED TO, THE FOLLOWING AREAS: WETLAND AREAS, AT POINTS OF CONCENTRATED FLOW, BELOW CULVERT OUTLET APRONS, AROUND CATCH BASINS AND CLOSED STORM SYSTEMS AND AT THE BOTTOM OF STEEP SLOPES THAT ARE MORE THAN 50 FEET FROM TOP TO BOTTOM.

**EROSION CONTROL MIX BERM**  
NOT TO SCALE

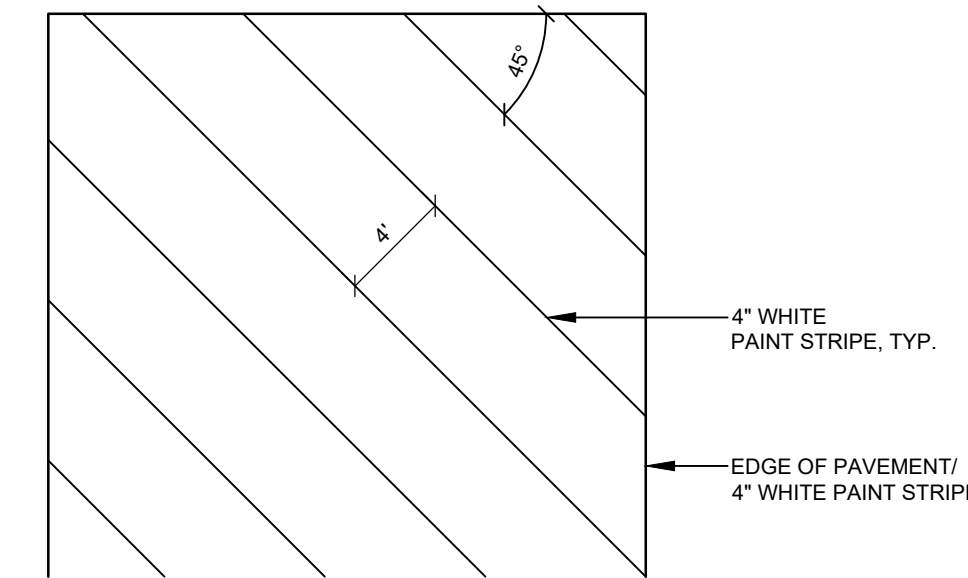

**DIAGONAL PAINT MARKINGS**  
NOT TO SCALE

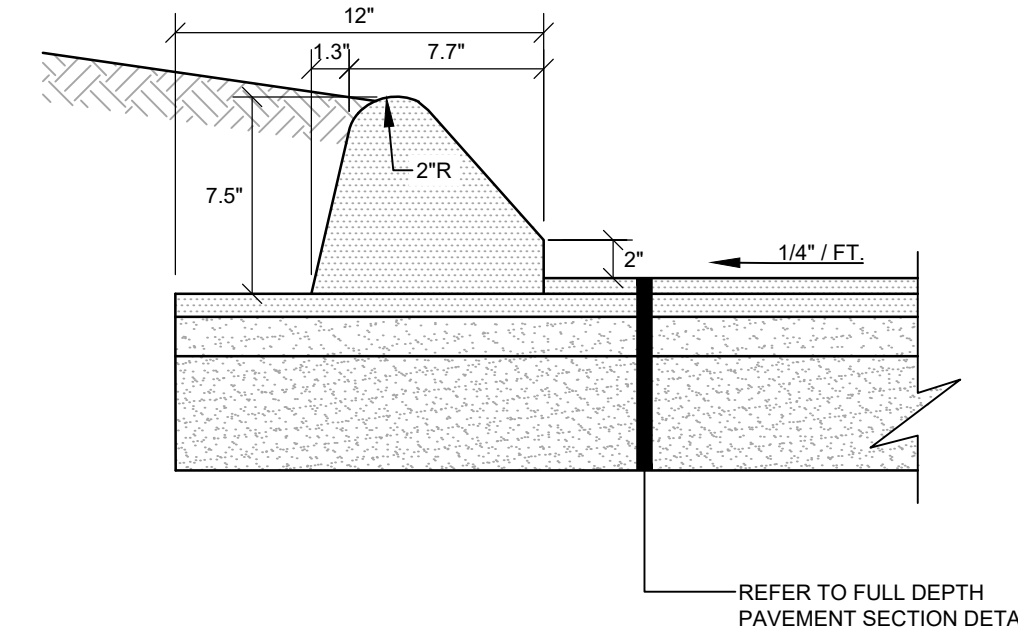

**BITUMINOUS CURB SECTION**  
NOT TO SCALE

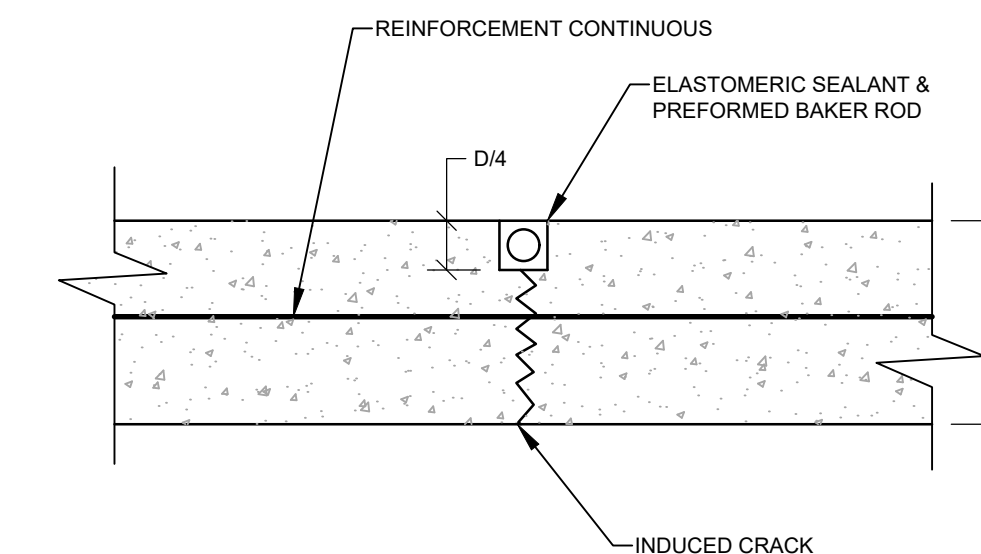

**CONTROL JOINT**  
NOT TO SCALE

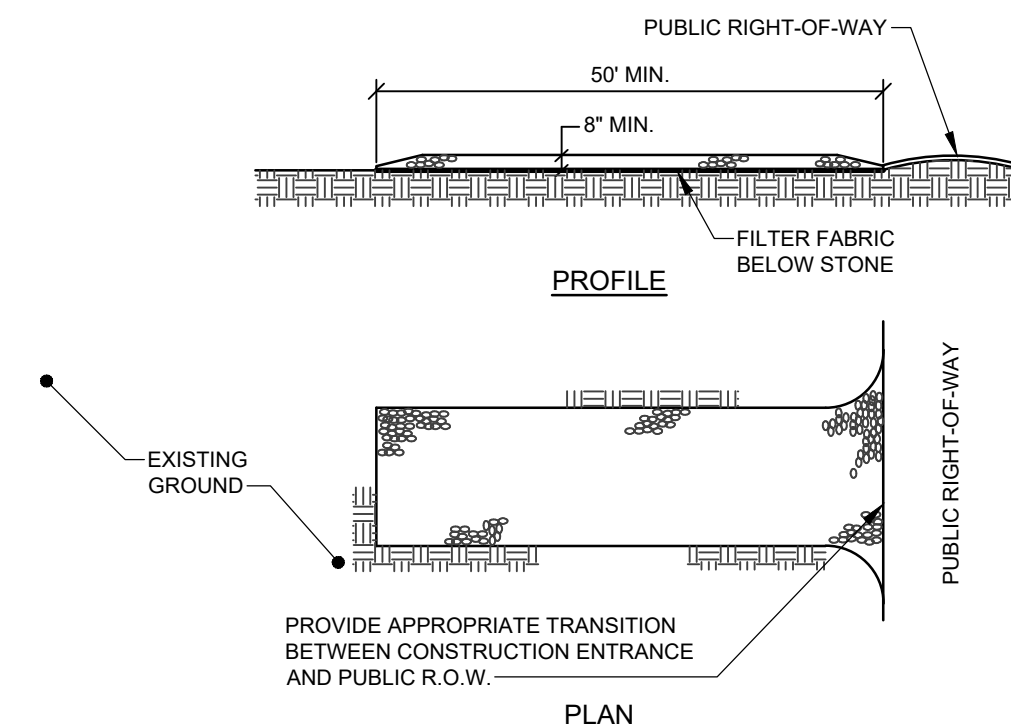

- NOTES:**
- STONE SIZE- AASHTO DESIGNATION M43, SIZE NO. 2 (2 1/2" TO 1 1/2"), USE CRUSHED STONE.
  - LENGTH- AS SHOWN ON PLANS, MIN. 50 FEET.
  - THICKNESS- NOT LESS THAN EIGHT (8) INCHES.
  - WIDTH- NOT LESS THAN FULL WIDTH OF ALL POINT OF INGRESS OR EGRESS.
  - MAINTENANCE- THE ENTRANCE SHALL BE MAINTAINED IN A CONDITION WHICH WILL PREVENT TRACKING OR FLOWING OF SEDIMENT ONTO PUBLIC RIGHT-OF-WAY. THIS MAY REQUIRE PERIODIC TOP DRESSING WITH ADDITIONAL STONE AS CONDITIONS DEMAND AND REPAIR AND/OR CLEANOUT OF ANY MEASURES USED TO TRAP SEDIMENT. ALL SEDIMENT SPILLED, DROPPED, WASHED OR TRACKED ONTO PUBLIC RIGHT-OF-WAY MUST BE REMOVED IMMEDIATELY.

**STABILIZED CONSTRUCTION ENTRANCE**  
NOT TO SCALE

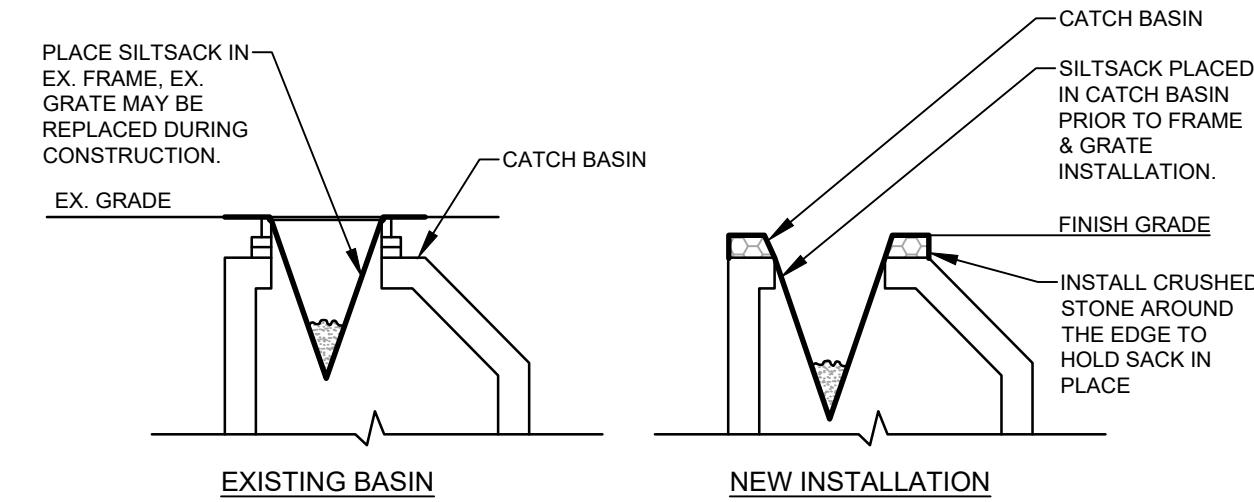

**NOTES:**  
PRIOR TO FINAL GRADING AND PAVING OPERATIONS BEGIN A CATCH BASIN INSERT (SUCH AS A SILT SACK OR A DANDY BAG II) MUST BE INSTALLED IN EACH BASIN PER MANUFACTURERS INSTRUCTIONS. HAY BALES SHOULD BE REMOVED ONCE INSERTS ARE INSTALLED.

**CATCH BASIN PROTECTION DETAIL**  
NOT TO SCALE

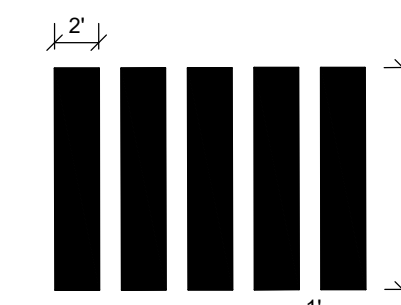

- PAVEMENT MARKING NOTES**
- ALL PAVEMENT MARKINGS SHALL BE IN CONFORMANCE WITH THE MANUAL ON UNIFORM TRAFFIC CONTROL DEVICES FOR STREETS AND HIGHWAYS, U.S. DOT, FHWA, LATEST EDITION.
  - ALL PAVEMENT MARKING LINES SHALL BE PAINT AND 4" WIDE, EXCEPT FOR: SWSL-12" SYCL-12" CROSSWALK BARS - 24"
  - PAVEMENT WORD AND SYMBOL MARKINGS SHALL BE WHITE PAINT.
  - SOLID WHITE STOP LINE SHALL BE A MINIMUM OF 4" BEHIND THE EDGE OF CROSSWALK.

**CROSSWALK DETAIL**  
NOT TO SCALE

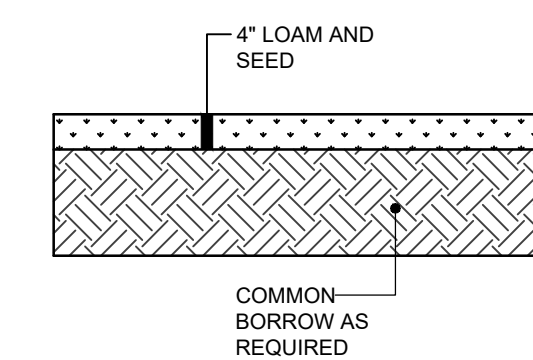

**LOAM & SEED SECTION**  
NOT TO SCALE

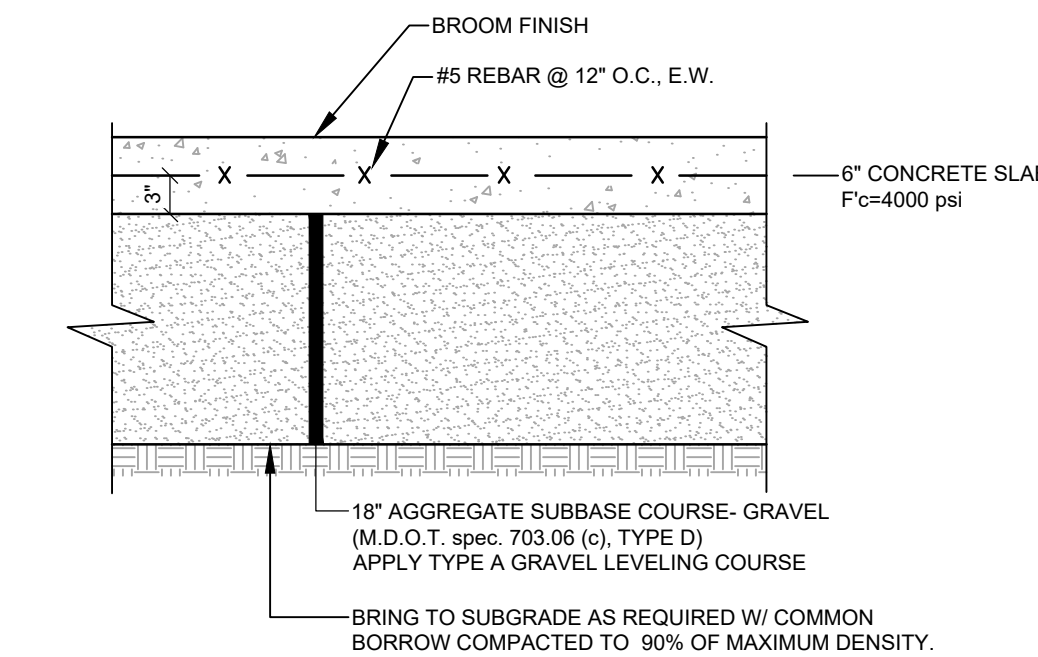

- NOTES:**
- COMPACT GRAVEL SUBBASE, BASE COURSE TO 95% OF MAXIMUM DENSITY USING HEAVY ROLLER COMPACTION.
  - CONTRACTOR SHALL SET GRADE STAKES MARKING SUBBASE AND FINISH GRADE ELEVATIONS FOR CONSTRUCTION REFERENCE.
  - PROOF ROLL SUBGRADE PER GEOTECHNICAL REPORT.

**TYPICAL CONCRETE DUMPSTER PAD**  
NOT TO SCALE

NOT FOR CONSTRUCTION

REV.	BY	DATE	STATUS
A	PDO	10/31/2023	ISSUED FOR BIDDING

THIS PLAN SHALL NOT BE MODIFIED WITHOUT WRITTEN PERMISSION FROM SEBAGO TECHNICS, INC. ANY ALTERATIONS, AUTHORIZED OR OTHERWISE, SHALL BE AT THE USER'S SOLE RISK AND WITHOUT LIABILITY TO SEBAGO TECHNICS, INC.

**SEBAGO**  
TECHNICS  
75 John Roberts Rd.  
Sullivan, ME 04106  
South Portland, ME 04106  
Tel. 207-200-2100  
WWW.SEAGOTECHNICS.COM

**EROSION CONTROL AND SITE DETAILS**  
OF:  
**LONG CREEK YOUTH DEVT. CENTER PAVING**  
675 WESTBROOK STREET  
SOUTH PORTLAND, MAINE 04106  
FOR:  
**MAINE DEPARTMENT OF CORRECTIONS**  
SHS 111, 25 TYSON DRIVE  
AUGUSTA, MAINE 04333

DESIGNED	BJB
DRAWN	ABB
CHECKED	PDO
DATE	06/15/2023
SCALE	NTS
PROJECT	230282

F:\Projects\230282\230282.dwg - 10/17/2023 9:32 AM - BRANDON BLAKE